

# MAGAIN



**1/14 Orange Grove Mitchell Park SA**

**3** **1** **3**

Nestled in a quiet and exclusive cul de sac position yet within walking distance to Flinders University & Medical Centre, this delightful North facing townhouse in a small group of 3 is sure to impress.

Offering a solid oak timber kitchen with overhead cupboards, a spacious formal lounge and dine area along with a casual living area that opens to a covered alfresco area with cafe blinds for year round entertaining.

Upstairs are three good sized bedrooms, 2 with robes and the master which opens out to it's own balcony.

The double garage has been converted into a rumpus/ 4th bedroom but could easily be returned to its original use.

The property also boasts brand new ducted reverse cycle air conditioning and the exterior has been recently painted. It is also perfectly positioned with respect to schools,

<b>Type</b>	: Townhouse
<b>Price</b>	: \$ 600,000
<b>Building Size</b>	: 146 sqm
<b>View</b>	: <a href="https://www.magain.com.au/property/114-orange-grove-mitchell-park-sa/755767">https://www.magain.com.au/property/114-orange-grove-mitchell-park-sa/755767</a>



**Jane Nelson**  
**0418 820 655**

[For full version visit the website](https://www.magain.com.au)

<https://www.magain.com.au>  
Magain Real Estate

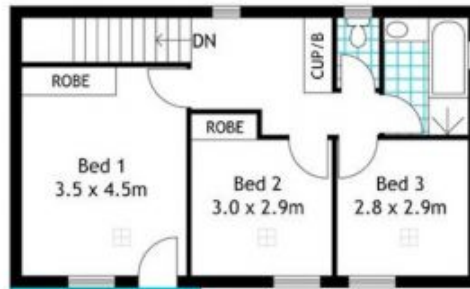

Upper Level Plan

Balcony



Lower Level Plan

Porch