

MAGAIN



29 Glyndale Grove Huntfield Heights SA

3 1 3

Please contact Jemma for all your property advice.

Situated in Huntfield Heights, just moments from Cardijn College, Noarlunga Centre, train station, Southern Expressway and just a short drive to Port Noarlunga Beach - you will find this wonderful home on a generous 743sqm (approx.) allotment offers a versatile floorplan, a comfortable living space and convenient location, making it an ideal choice for families, first home buyers, investor and developers (STCC) .

Upon arrival you'll love the low maintenance and spacious front yard with ample amount off street parking and additional drive through access through to a double garage towards the back of the home.

[For full version visit the website](https://www.magain.com.au/property/29-glyndale-grove-huntfield-heights-sa/7713157)

Type	: House
Price	: \$ 575,000
Building Size	: 117 sqm
Land Size	: 743 sqm
View	: https://www.magain.com.au/property/29-glyndale-grove-huntfield-heights-sa/7713157



Jemma Turner
08 8266 2220

<https://www.magain.com.au>
Magain Real Estate

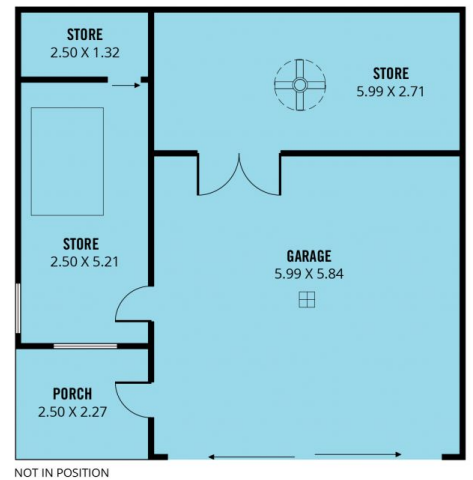

Scale in metres. This drawing is for illustration purposes only. All measurements are approximate and details intended to be relied upon should be independently verified.

Produced by **The Fotobase Group**