

MAGAIN



7 Shiraz Court Aberfoyle Park SA

5 2 2

Please contact Josh Morrison for all your property advice

If this is what they mean by "give me a home amongst the gum trees", then we're all for it! Sitting on an incredible allotment of 1224m2 (approx.), this multi-level family home offers scenic views, excellent entertaining and has been stylishly updated with a very functional layout.

With an attractive street appeal, step inside to find multiple living spaces downstairs boasting plenty of natural light and high ceilings. Comforts are catered for with a gas heater and fireplace for those cooler nights, whilst you are spoilt for choice with evaporative cooling for those warm summer days. The open plan leads through to the sparkling

[For full version visit the website](https://www.magain.com.au/property/7-shiraz-court-aberfoyle-park-sa/8169593)

Type	: House
Price	: \$ 1,100,000
Building Size	: 152 sqm
Land Size	: 1224 sqm
View	: https://www.magain.com.au/property/7-shiraz-court-aberfoyle-park-sa/8169593



Josh Morrison
08 8294 4111



Steve Krause
08 8294 4111

<https://www.magain.com.au>
Magain Real Estate

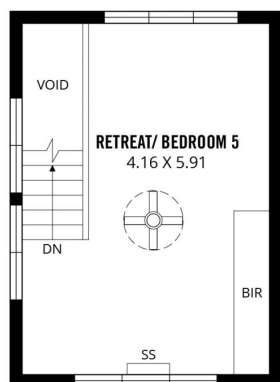

FIRST FLOOR

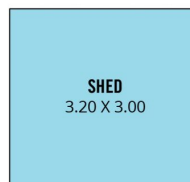

NO IN LOCATION



GROUND FLOOR

