

# MAGAIN



## 961 Cleland Gully Road Tooperang SA

4 1 5

Please contact Nathan Brown and Michelle Draper from Magain Real Estate for all your property advice.

This amazing 5-acre property features a solid 4-bedroom 1910 built stone cottage, offering potential for renovation and extension. Unique and full of character with stunning floorboards and high ceilings in the bedrooms and hallway, the home includes a large living room with a combustion heater and wall unit r/c air conditioner for year-round comfort. The property has a neutral bathroom, practical kitchen, and a spacious separate laundry. A generous undercover outdoor area provides a stunning outlook, perfect for entertaining or use as a carport. A large, powered shed with mezzanine, auto door, and 3-phase power offers ample storage, machinery space, and room

**Type** : Acreage/Semi-Rural  
**Price** : \$ 910,000  
**Building Size** : 130 sqm  
**Land Size** : 2.06 ha  
**View** : <https://www.magain.com.au/property/961-cleland-gully-road-tooperang-sa/8258005>



**Nathan Brown**  
08 8298 1494



**Michelle Draper**  
08 8298 1494

[For full version visit the website](https://www.magain.com.au)

<https://www.magain.com.au>  
Magain Real Estate

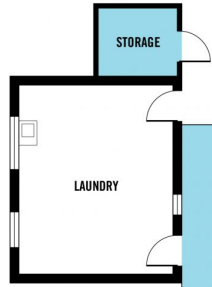
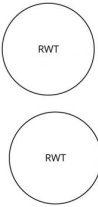
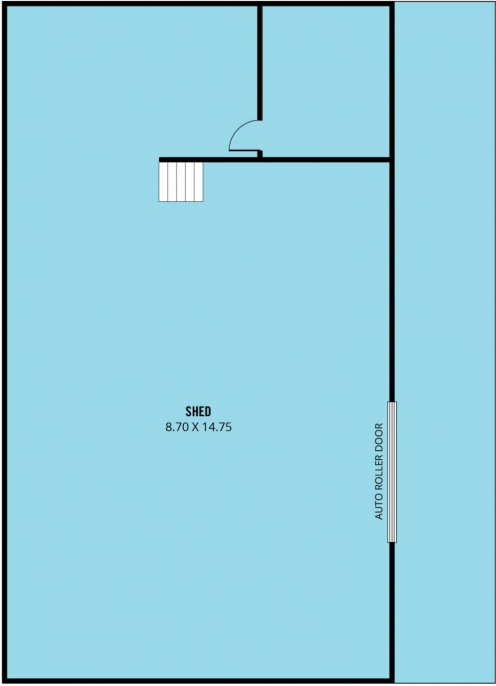

SHED  
1.80 X 0.80

