

MAGAIN



9/190 Morphett Road GLENGOWRIE SA

2 1 1

This well maintained townhouse is ideally located in this highly sought after location only a short distance to shopping centres, parks, schools & transport.

Downstairs offers a spacious formal lounge and separate dining area, good sized kitchen with dishwasher and ample cupboards, separate laundry and 2 WC.

The air conditioned upstairs section offers two large bedrooms, main with walk in robe and balcony and both have electric roller blinds for security and privacy. The bathroom also has a spa bath.

Other features include large private front and rear gardens, carport plus extra parking, Foxtel and ADSL. There is even a cat run - cats are allowed.

The group is delightful and also offers a large central park area where you can entertain or the kids can play.

[For full version visit the website](https://www.magain.com.au/property/91-90-morphett-road-glengowrie-sa/8421699)

Type : Townhouse
Building Size : 11 sqm
View : <https://www.magain.com.au/property/91-90-morphett-road-glengowrie-sa/8421699>



Jane Nelson
08 8277 1777

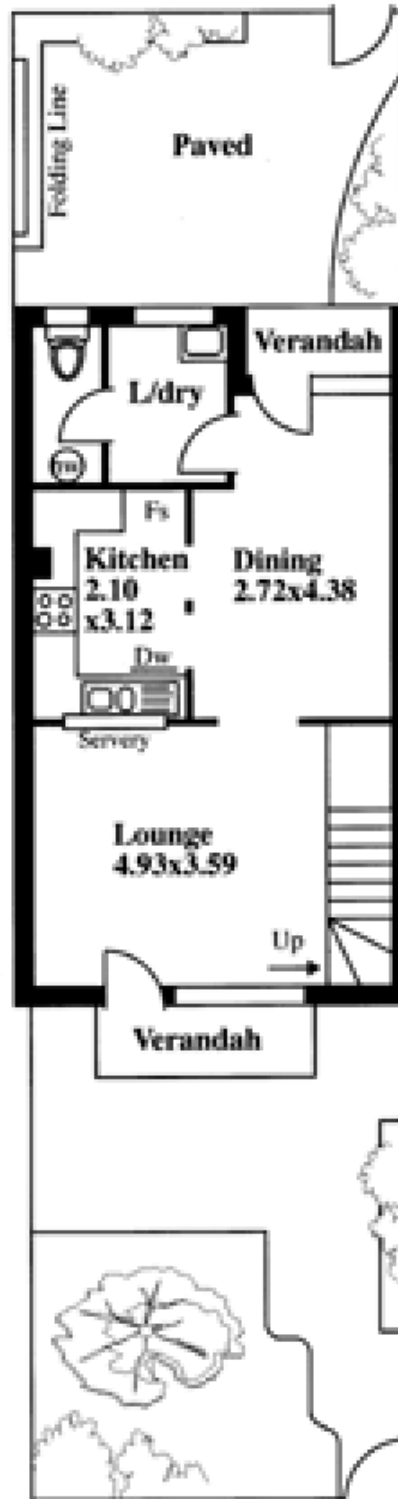
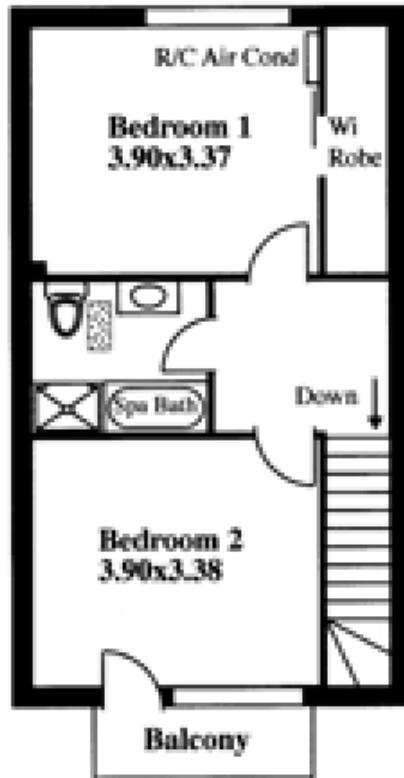

LEGEND
 Sky light