

MAGAIN



2 Bloomsbury Court WOODCROFT SA

3 1 1

Located in a quiet court only a short walk to shops, schools and transport is this lovely, spacious villa home that offers lots of extras for the young couple looking to get into this ever increasing market or those wanting to downsize not compromise. Featuring two tiled separate living areas, three bedrooms with floating floors, master bedroom with walk in robe and two way ensuite bathroom, built in robes and ceiling fans in all bedrooms and kitchen with pantry overlooking the open plan family/dine. Outside offers low maintenance gardens with automated, underground drippers, paved pitched pergola for year round entertaining and lock up garage with automatic roller door with internal access. So many extras including ducted evaporative cooling, gas heating, deadlocks, window locks and insulation. An affordable yet neat home you can just move

Type : House
Building Size : 16 sqm
Land Size : 358 sqm
View : <https://www.magain.com.au/property/2-bloomsbury-court-woodcroft-sa/8421885>

[For full version visit the website](https://www.magain.com.au)

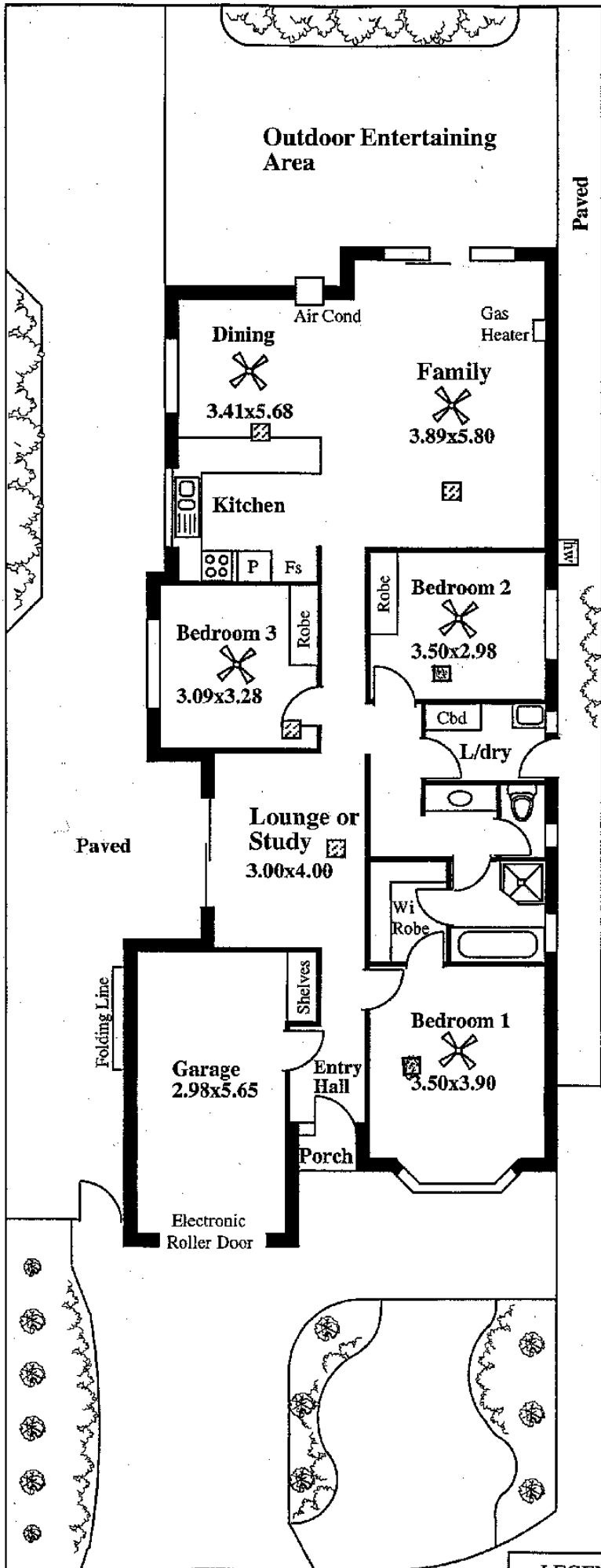

LEGEND
 [Symbol] Air cond ducts