

MAGAIN



2 Esther Drive WOODCROFT SA

3  2  2 

Absolute Value.... Need more room to grow? Looking for something with two living areas, that is walking distance to shops, schools and bus and is located opposite a park and playground? This lovely three bedroom home is deceptively spacious and offers ensuite and walk in robe to the master, formal lounge and dine with ducted air and gas heating and sparkling bathroom with spa bath. Outside is ideal for entertaining and offers an all weather pitched pergola as well as parking for the car AND the caravan or boat! So many added extras including built in robes, ceiling fans, security system and dishwasher. Attractive and affordable, it really is worth your inspection. Phone Mike on 0417877219 for further information.

Type : House
Building Size : 17 sqm
Land Size : 629 sqm
View : <https://www.magain.com.au/property/2-esther-drive-woodcroft-sa/8421893>

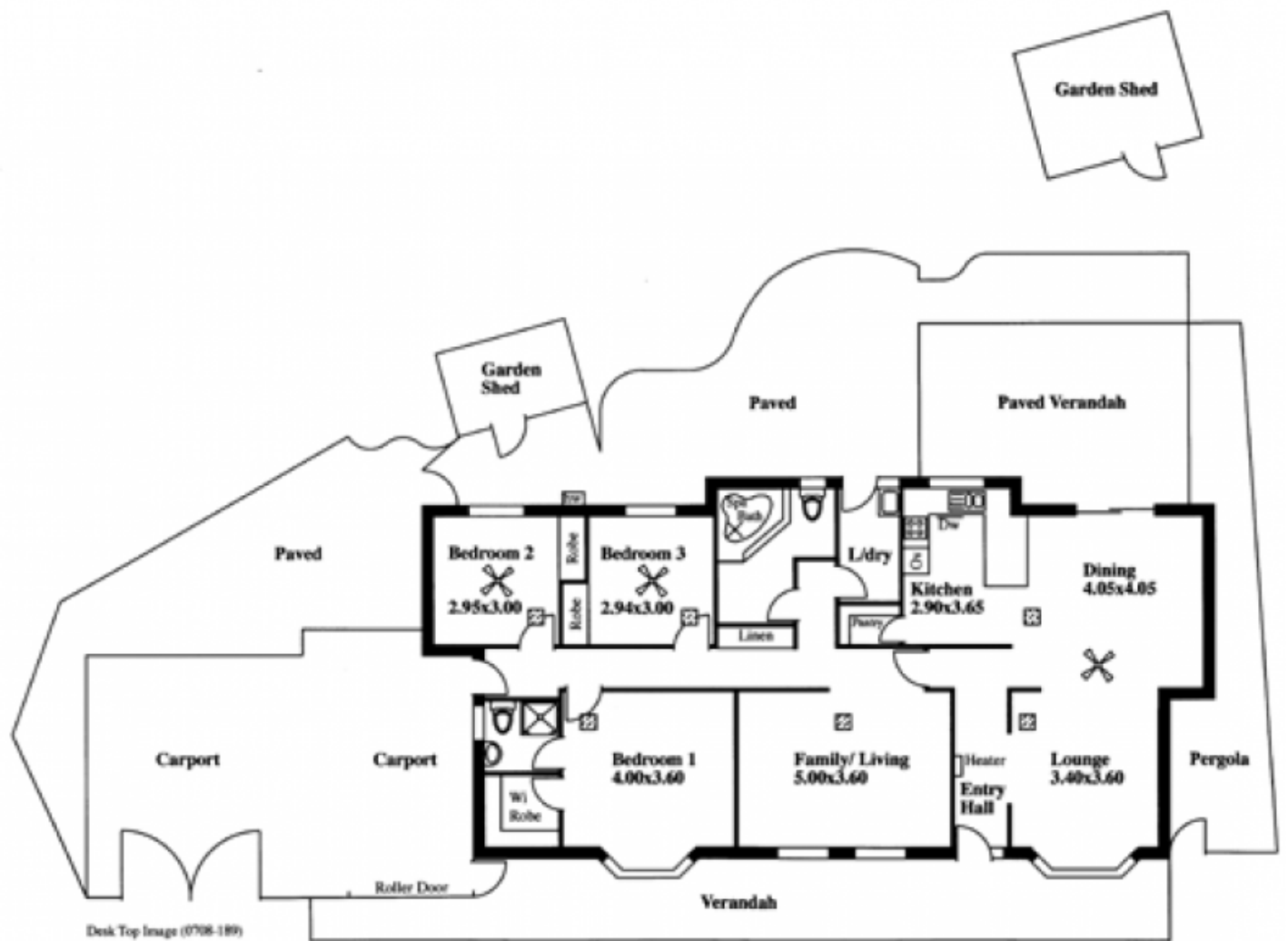

Desk Top Image (0708-189)