



MAGAIN



10 Tait Avenue MARION SA

3  1  2 

The perfect setting in one of the most sought after locations in the Marion area, the "Original Oaklands Character Estate", much loved and very comfortable, privately tucked away in this tightly held position, just a few minutes walk to Westminster school.

Offering three very good size bedrooms, high ceilings, timber floors beneath existing carpets, separate lounge room, big formal dining room, plus a lovely updated kitchen with dishwasher, loads of cupboards and big pantry.

With lovely grounds well hidden by high brush fencing and plenty of play room front and back, this solid brick family home is a short walk to gorgeous parklands, nearby kindergarten, swimming centre and good local shopping.

[For full version visit the website](https://www.magain.com.au/property/10-tait-avenue-marion-sa/8421949)

Type : House
Building Size : 15 sqm
Land Size : 580 sqm
View : <https://www.magain.com.au/property/10-tait-avenue-marion-sa/8421949>

Garden Shed

10 Tait Avenue, Marion

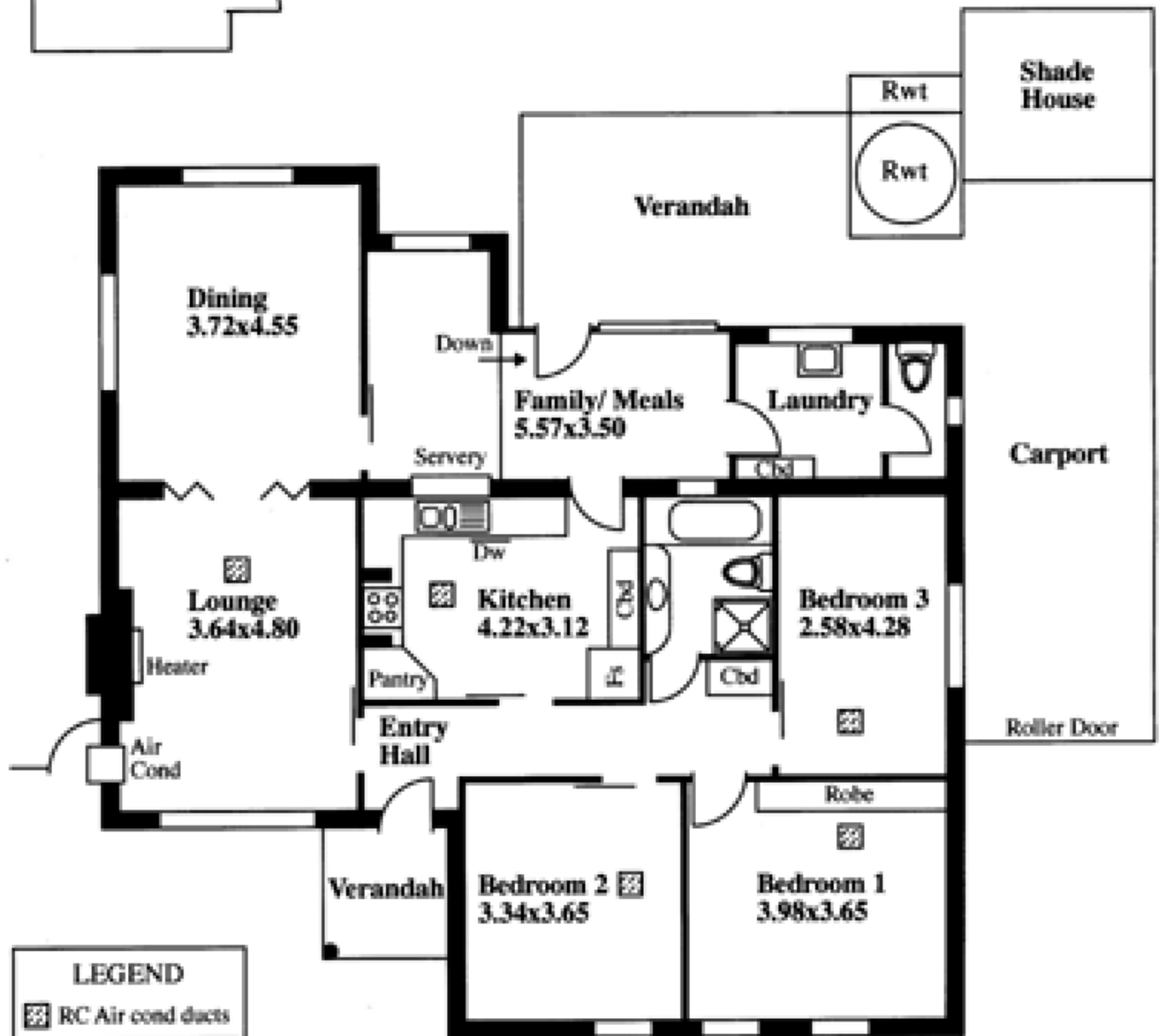

This drawing is for illustration purposes only
(Drawing is not to scale)

The drawing and the information contained is not intended to be part of any contract. All measurements are approximate and details intended to be relied upon should be independently verified.

Desk Top Image (1008-40)