

# MAGAIN

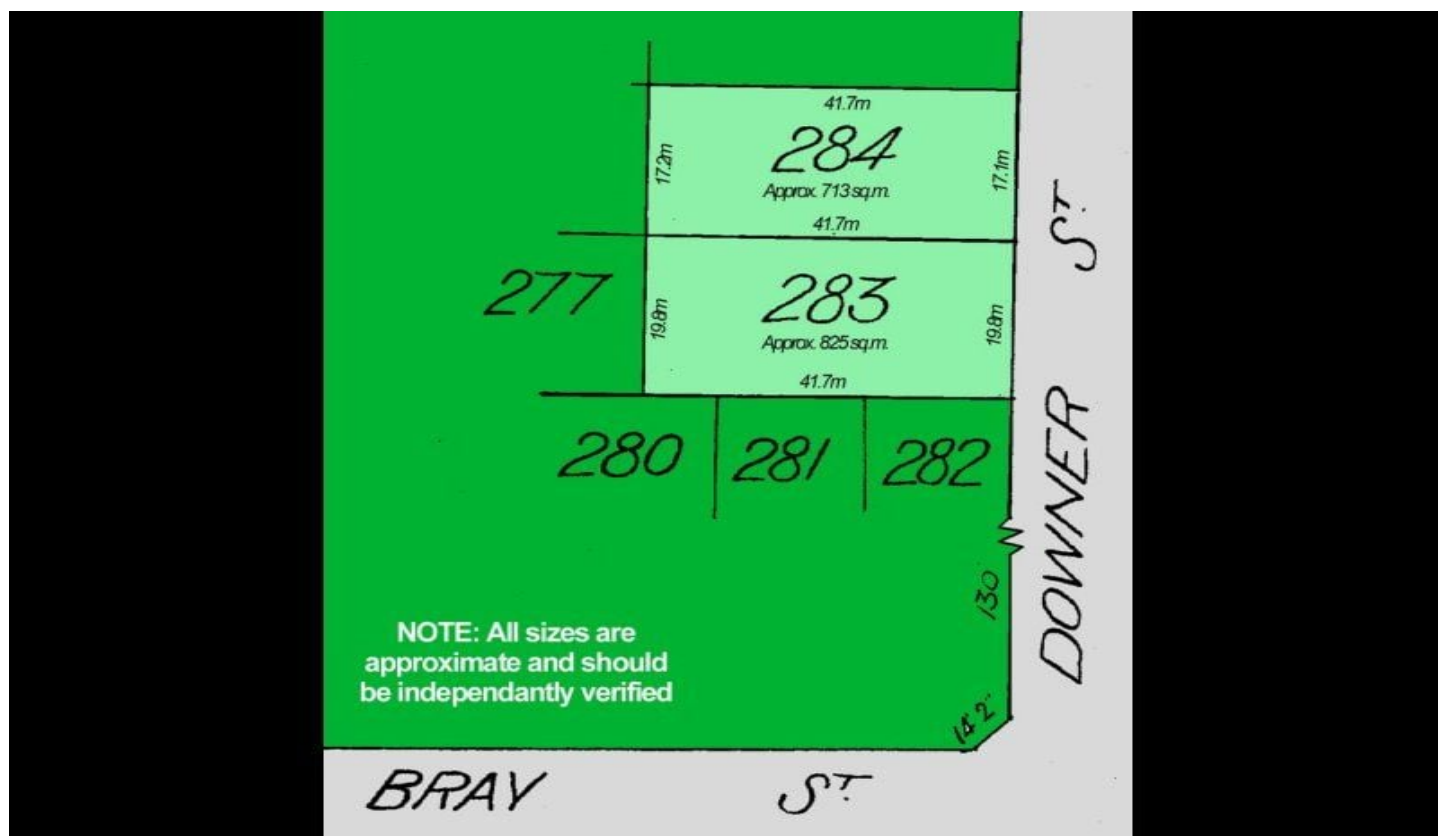

## 17 Downer Street PLYMPTON PARK SA

3 🏠 1 🏡

These two homes in Downer Street will be of interest to the buyer seeking a much larger potential site, ideal for the new home builder and or developer with other plans in mind and with a combined frontage of approx 36.86m and each with a depth of approx 41.76m.

**Type** : House  
**View** : <https://www.magain.com.au/property/17-downer-street-plympton-park-sa/8422128>

The current owners reside in one of these homes and rent out the other property next door and have proposed plans to council for the possible building of six new dwellings subject of course, to obtaining the usual consents and approvals necessary.

Handy to bus, schooling, tram and good local shopping, and just a few minutes to the bay area of Glenelg, to register your interest, view plans or obtain a copy of each

[For full version visit the website](https://www.magain.com.au)