

MAGAIN



ASCOT PARK

3  1  3 

this original family home will be hard to beat for the best value start this year, solid brick, tiled roof, solid timber floors beneath existing carpets, big back garden, lockup carport, rear verandah and plenty of room for the kids to play.

the separate front lounge room has high ceilings and gas heating, the kitchen meals area with gas oven is original, as is the bathroom, there is a separate laundry and bedroom three is currently used as a separate dining room.

situated on the northern border of Ascot Park adjacent to South Plympton and in need of updating & refurbishment, the home also has plenty of room to add further extensions, subject to obtaining all of the usual council consents.

[For full version visit the website](#)

Type : House
Building Size : 11 sqm
Land Size : 610 sqm
View : <https://www.magain.com.au/property/ascot-park/8422560>

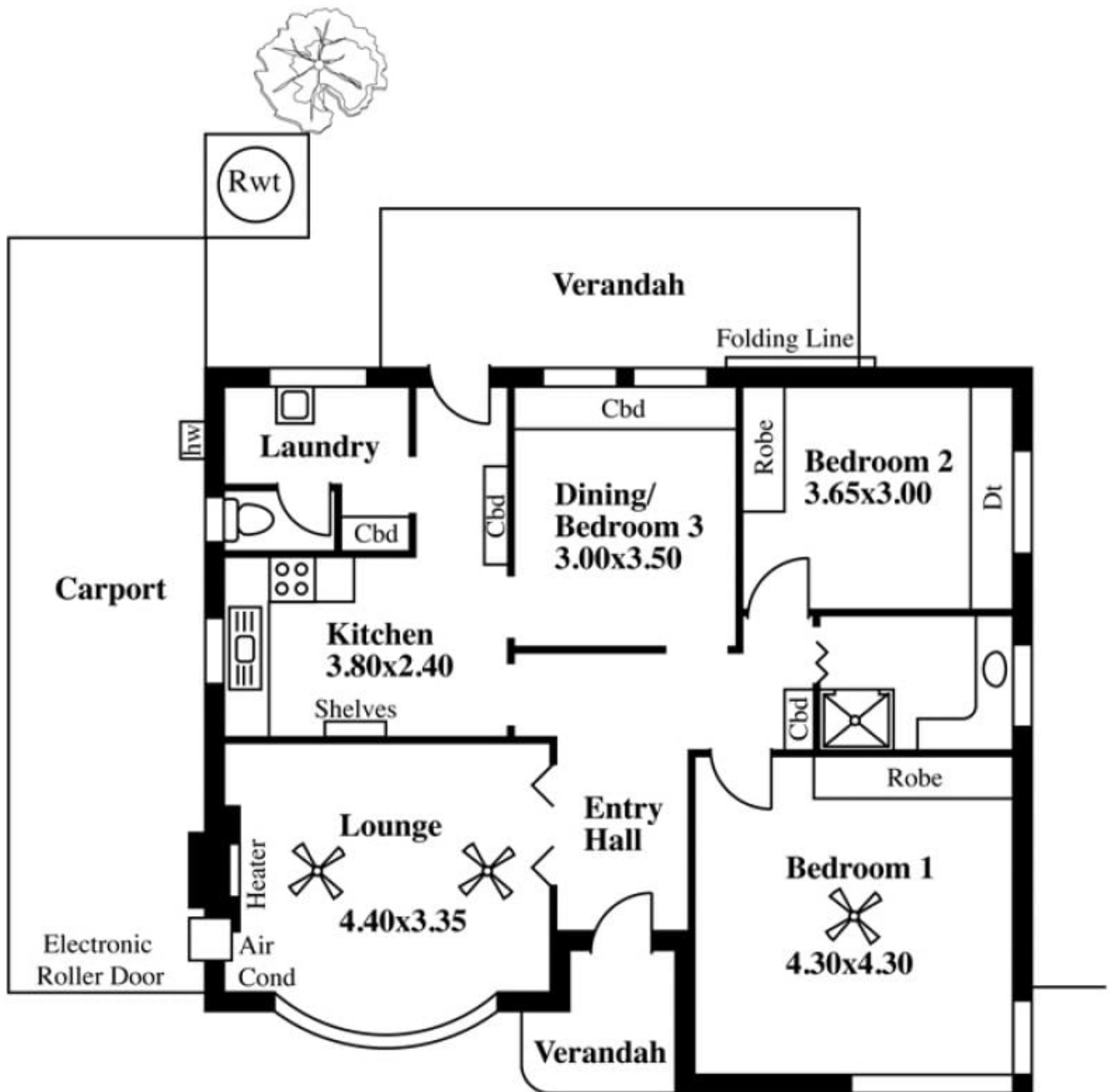

10/10/2023