

MAGAIN



63/19 South Terrace ADELAIDE SA

Sited in a large Strata group in a convenient location opposite Parklands, this well presented air conditioned one bedroom unit offers an outstanding opportunity to invest at a realistic price.

Ample off street parking at the rear.

Currently tenanted at \$200 per week to an excellent tenant until November 2014, it confirms that you will have guaranteed income.

1  1  1 

Type : Unit
Building Size : 4 sqm
View : <https://www.magain.com.au/property/63-19-south-terrace-adelaide-sa/8422569>



Jane Nelson
08 8277 1777

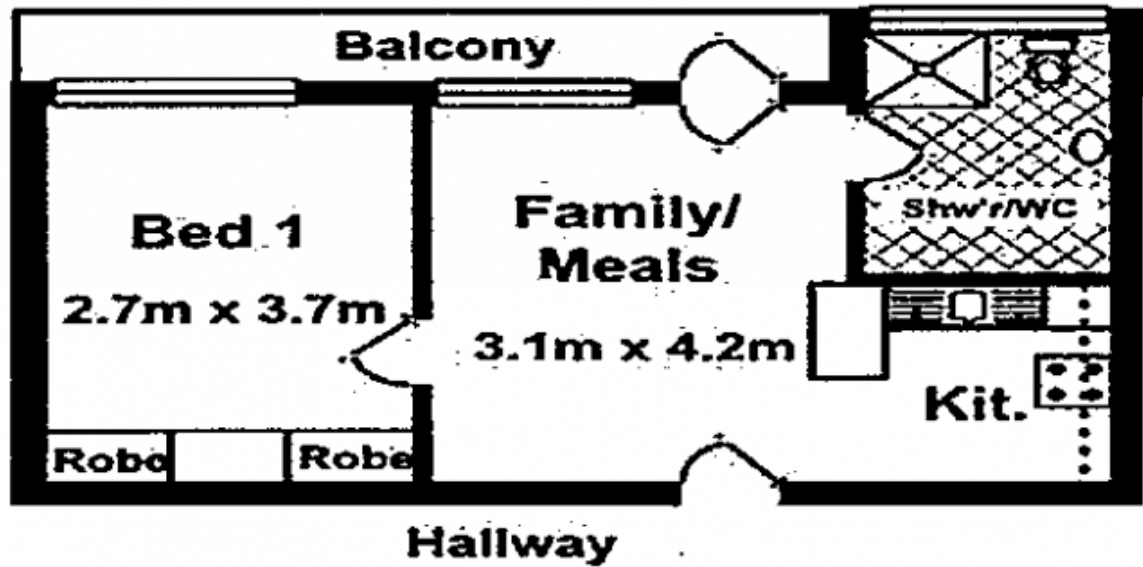

Shared Laundry - Ground Level

Shared Parking - Ground Level