

MAGAIN



www.rpdata.com



18-9 East Terrace ADELAIDE SA

2 1 1

just a few steps to cafe's, restaurants, museum, library, Adelaide Uni and the botanic gardens, this lovely secure east facing apartment on level four is opposite the East parklands and an easy walk to Rundle Street shopping precinct and the Royal Adelaide Hospital.

Type : Apartment
Building Size : 10 sqm
View : <https://www.magain.com.au/property/18-9-east-terrace-adelaide-sa/8422601>

With secure lockup garage parking for total peace of mind, the lifestyle includes two good size bedrooms both with built in robes, lovely big kitchen, nicely tiled bathroom, lounge & dine with neutral decor and plenty of room to relax on a large fully tiled balcony with covered verandah.

Built in 1999 this apartment is ideal for the couple seeking inner city convenience to move in immediately or an investment providing a return of approx \$400 per week

[For full version visit the website](#)

<https://www.magain.com.au>
Magain Real Estate

765 Marion Road Ascot Park SA
08 8277 1777

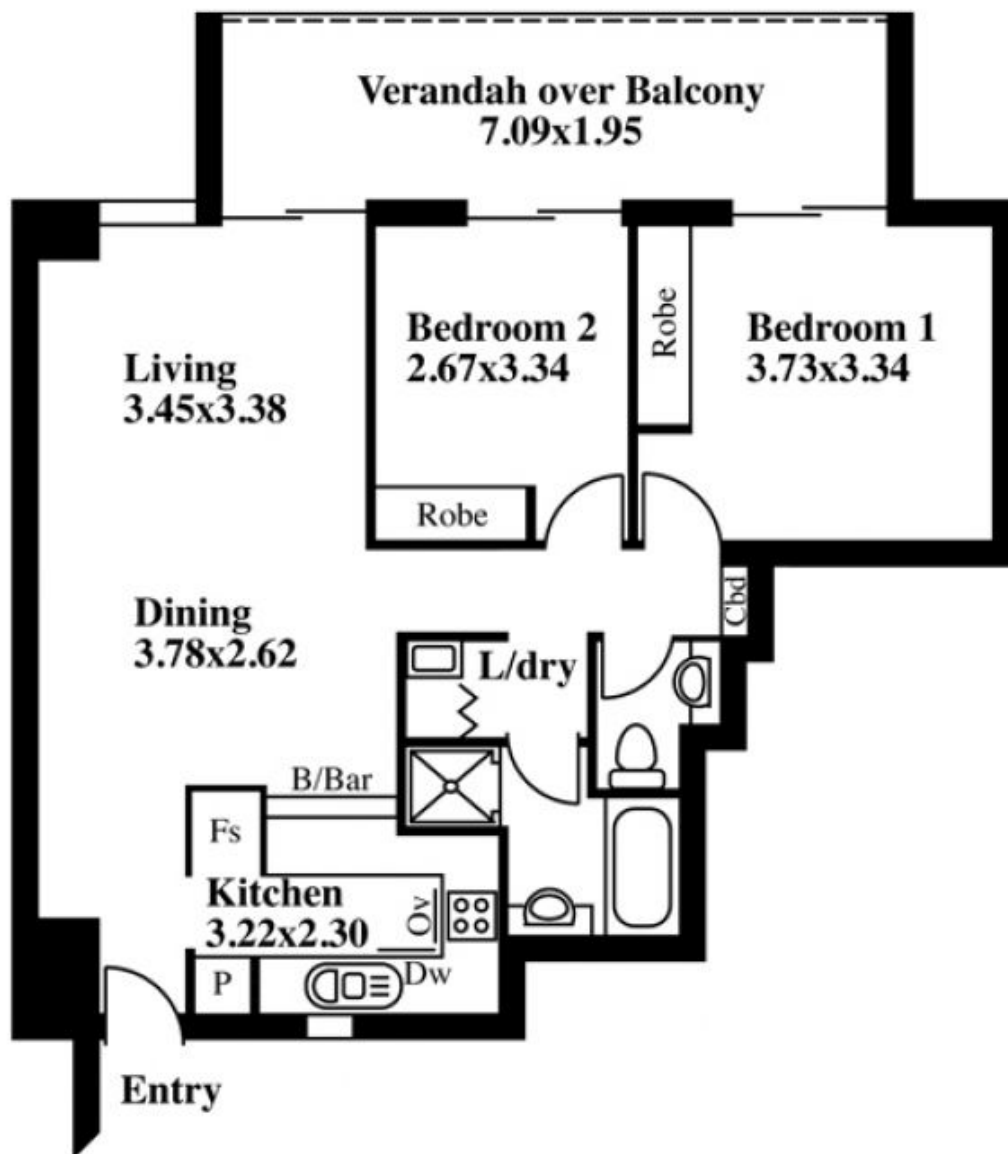

ESTIMATE OF AREA

UNIT 75.45 Square metres/ 8.11 Squares

BALCONY 14.73 Square metres/ 1.58 Squares