

MAGAIN

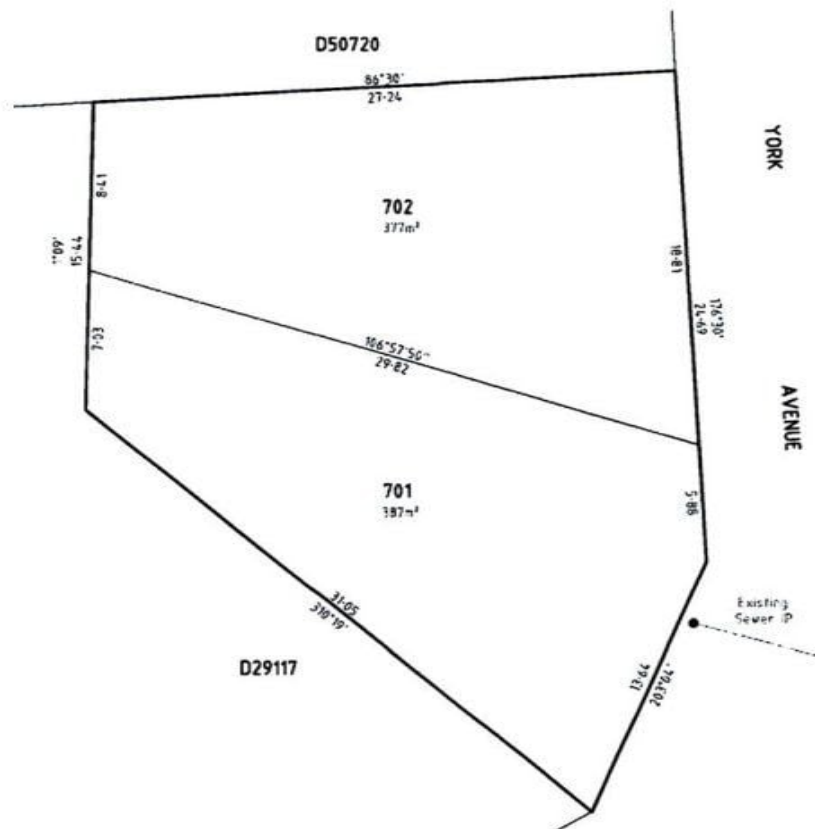

702 York Avenue CLOVELLY PARK SA

fresh on the market, this nicely situated allotment will suit the home buyer seeking plenty of room to build their brand new home with a nice wide frontage, with no restrictions on your choice of builder who will help you design your own house plans.

approximately 15 - 20 minutes to the city and a short drive to Marion & Flinders Medical Centre with convenience to bus, train and good local shopping, be early to register your interest or view plans by contacting our local property consultant Rick Connock on 0403255666.

Lot 701 is sold and lot 702 is for sale with wide frontage at an asking price of \$248,000 - 258,000.

Type : Land
Land Size : 377 sqm
View : <https://www.magain.com.au/property/702-york-avenue-clovelly-park-sa/8422683>

