

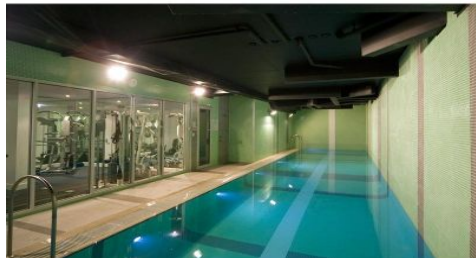



MAGAIN



211/211 Grenfell Street ADELAIDE SA

3  2  1 

ITS ALL ABOUT THE SIZE AND LOCATION

This Stunning, unique apartment over 2 levels in the popular East End has

- 3 Bedrooms,
- Huge main with balcony access
- 2.5 bathrooms, toilet on both levels
- Huge open plan dining/ living
- Stunning kitchen with gas & Miele appliances
- Private balconies on both levels
- Extra storage cupboards through out
- ADSL & Foxtel ready

Type : Unit
Building Size : 152 sqm
View : <https://www.magain.com.au/property/211211-grenfell-street-adelaide-sa/8423029>

[For full version visit the website](https://www.magain.com.au)

<https://www.magain.com.au>
Magain Real Estate

765 Marion Road Ascot Park SA
08 8277 1777

Appt. 211/211 Grenfell Street, Adelaide

APPROXIMATE ESTIMATED AREA	
Living	69.2
Lower Living	69.7
Balconies	13.2
<hr/>	
TOTAL	152.1 sqm. app.

☒ A/C outlets

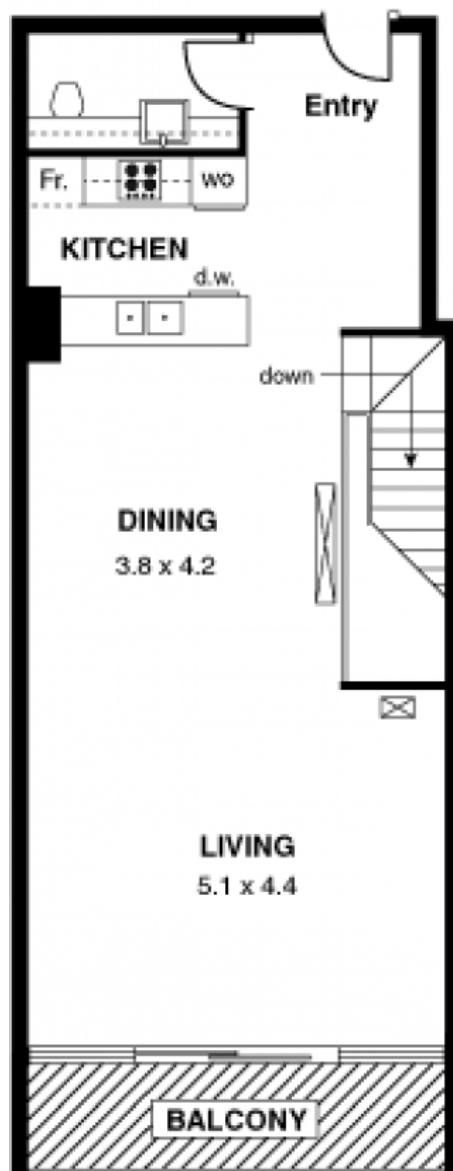

Lower Living

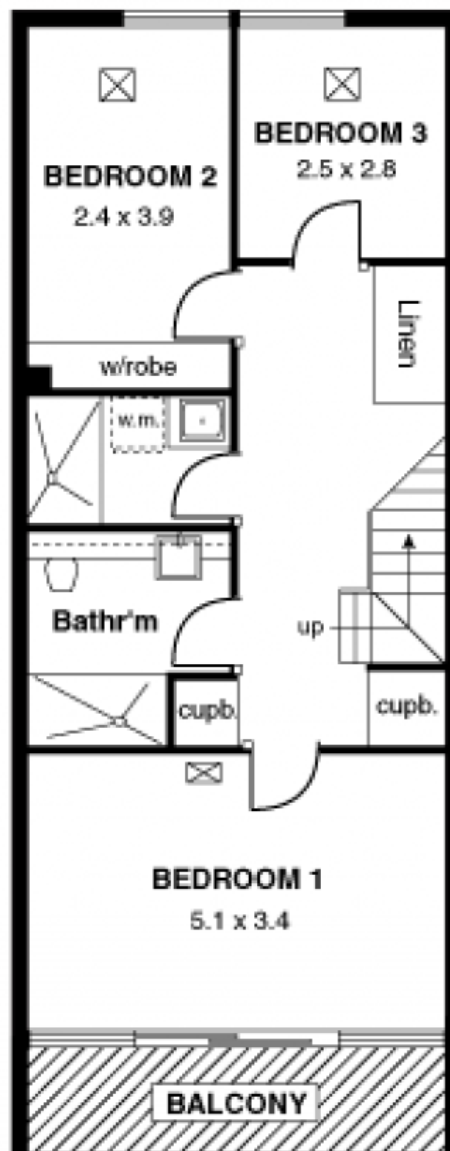

Every care has been taken to verify the correctness of areas and details used in this leaflet. However no warranty or representative is given or made as to the correctness of information supplied, and neither the owners nor the agent can accept responsibility for errors or omissions.
 Imaging House Advertising, 168 Halifax Street, Adelaide 5000