

MAGAIN



5 Muscatel Avenue WATTLE PARK SA

4  1  2 

Very spacious family home

- 4 Bedrooms
- Separate Rumpus /Study
- Open plan Kitchen/Dine/Living
- Double carport
- Set on a leafy site of approx 780 sqm
- A fantastic location to live in

Amongst fine homes in the foothills

Price: \$660,000-\$690,000

Auction: Saturday 10th March at 10.30am (unless sold prior)

Jim Phillis 0418 828 638

Property Code: 403907226

Type : House
Building Size : 162 sqm
Land Size : 780 sqm
View : <https://www.magain.com.au/property/5-muscatel-avenue-wattle-park-sa/8423332>

5 Muscatel Avenue, Wattle Park

APPROXIMATE ESTIMATED AREA

Living	133.1
Upper Living	22.9
Balcony	6.2
Carpport	32.4
TOTAL	194.6 sqm. app.

Every care has been taken to verify the correctness of areas and details used in this leaflet. However no warranty or representative is given or made as to the correctness of information supplied, and neither the owners nor the agent can accept responsibility for errors or omissions. Imaging House Advertising, 168 Halifax Street, Adelaide 5000

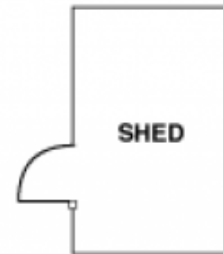

Upper Living

