

MAGAIN



14/172 Wakefield Street ADELAIDE SA

2  1  2 

MODERN TOWNHOUSE IN CONVENIENT CBD LOCATION!

Modern in construction, Convenient in Location, this well presented 3 level Townhouse is ideally situated in the CBD and will appeal to the city professionals, 1st home buyers or investors.

Feature include:-

- 2 good sized bedrooms with built in robes
- Modern kitchen with Stainless appliances & D/W
- Spacious dining/living with timber flooring
- Reverse cycle air conditioning/ intercom access
- Stylish central bathroom
- Large private balcony
- Light & Airy through - out

[For full version visit the website](https://www.magain.com.au/property/14-172-wakefield-street-adelaide-sa/8423375)

Type : Townhouse
Building Size : 132 sqm
View : <https://www.magain.com.au/property/14-172-wakefield-street-adelaide-sa/8423375>

Ground Level

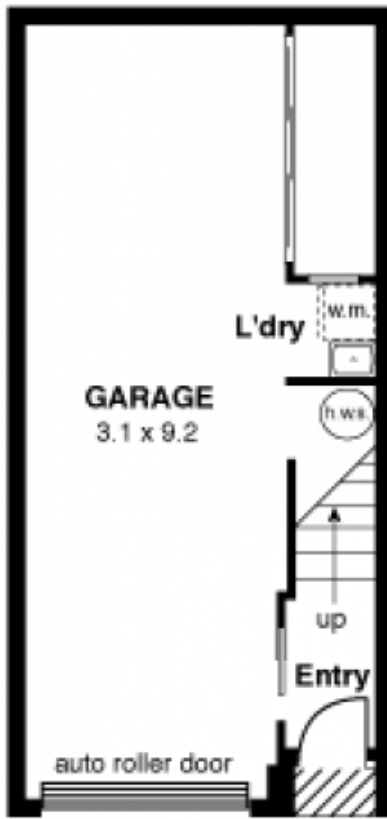

Level 1.

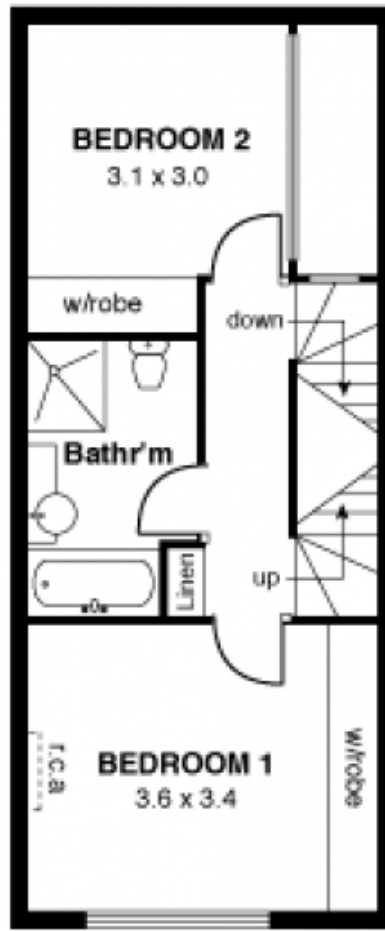

Level 2.



APPROXIMATE ESTIMATED AREA

Ground Level	43.4
Level 1.	46.7
Level 2.	35.8
Balcony	10.3
TOTAL	136.2 sqm. app.

Every care has been taken to verify the correctness of areas and details used in this leaflet. However no warranty or representative is given or made as to the correctness of information supplied, and neither the owners nor the agent can accept responsibility for errors or omissions.

Imaging House Advertising, 168 Halifax Street, Adelaide 5000

Ground Level

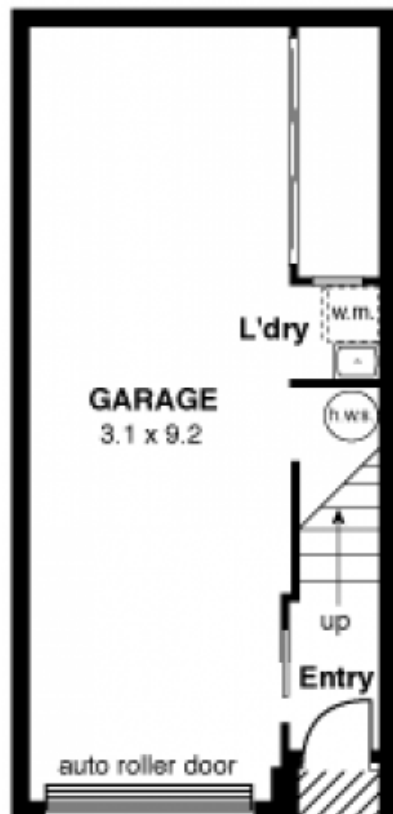

Level 1.

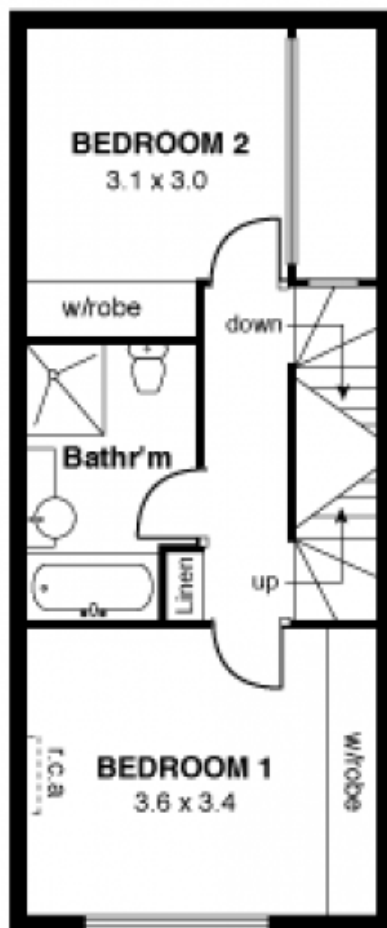

Level 2.



APPROXIMATE ESTIMATED AREA

Ground Level	43.4
Level 1.	46.7
Level 2.	35.8
Balcony	10.3
TOTAL	136.2 sqm. app.

Every care has been taken to verify the correctness of areas and details used in this leaflet. However no warranty or representative is given or made as to the correctness of information supplied, and neither the owners nor the agent can accept responsibility for errors or omissions.

Imaging House Advertising, 168 Halifax Street, Adelaide 5000