

MAGAIN



3/12 Toms Court ADELAIDE SA

2 2 2

STYLE AND CONVENIENCE AWAITS!

This well presented, modern 3 level townhouse is perfectly positioned in the CBD, corner of King William & Halifax Streets and will suit the city professional, 1st home buyers or investors.

Features:-

- 2 well sized bedrooms, both with built - ins
- Valuable central study area
- 2 sparkling bathrooms
- Modern kitchen with gas & Euro appliances
- Spacious dining/lounge area with timber flooring
- Separate fold away laundry
- Ducted reverse cycle air conditioning
- Secure intercom access/ alarm system
- Internal balcony/light well

[For full version visit the website](https://www.magain.com.au/property/31-2-toms-court-adelaide-sa/8423385)

Type : Townhouse
Building Size : 163 sqm
View : <https://www.magain.com.au/property/31-2-toms-court-adelaide-sa/8423385>

3/12 Toms Court, Adelaide

Ground Level

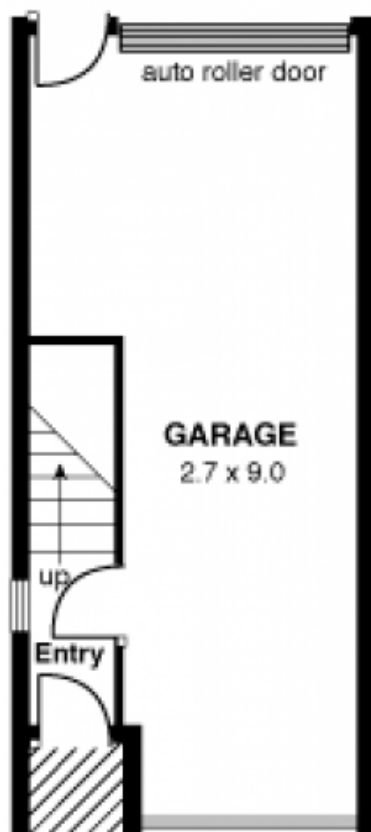

Level 1.

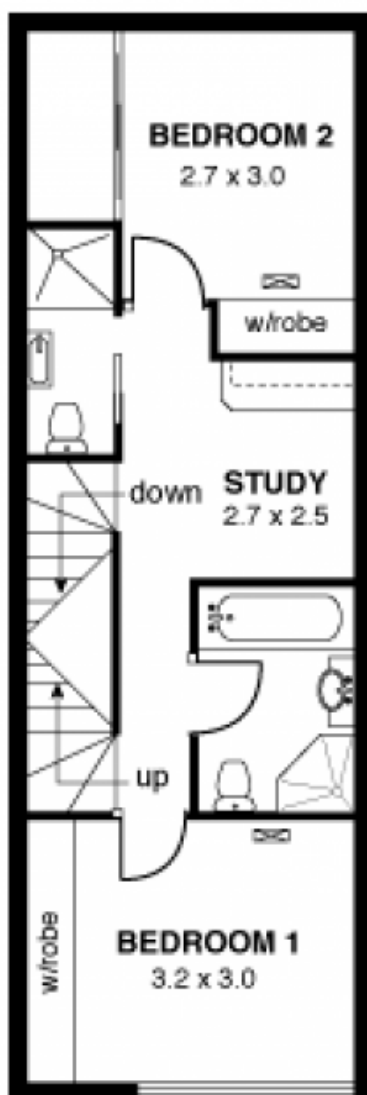

Level 2.

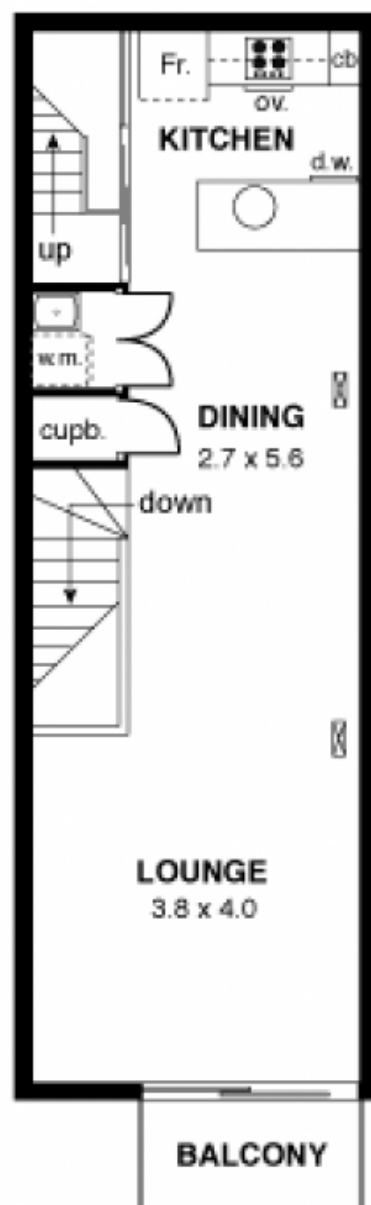

Level 3.

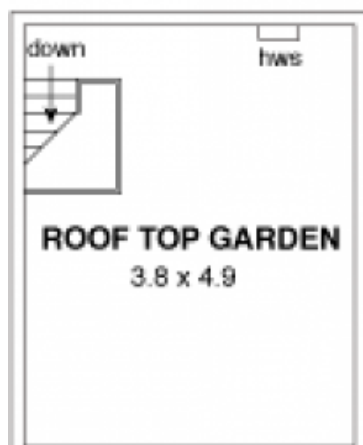

APPROXIMATE ESTIMATED AREA

Ground Level	37.8
Level 1	52.0
Level 2	49.3
Porch	1.1
Balcony	3.3
Roof Top Garden	18.6
TOTAL	162.1 sqm. app.

 air con. outlets

Every care has been taken to verify the correctness of areas and details used in this leaflet. However no warranty or representative is given or made as to the correctness of information supplied, and neither the owners nor the agent can accept responsibility for errors or omissions.

Imaging House Advertising, 168 Halifax Street, Adelaide 5000