

MAGAIN



14/4 Shepherds Hill Road BEDFORD PARK SA

2  **1** 

This stylish and trendy ground floor unit has

- 2 Good sized bedrooms
- Well appointed modern kitchen
- Large dining/ lounge
- Floating floorboards throughout
- Split system air - conditioner

Fantastic opportunity!

Close to public transport, Westfield shopping, Flinders Medical and more!

Stacey Salonikis 0412052679

Type : Unit

View : <https://www.magain.com.au/property/144-shepherds-hill-road-bedford-park-sa/8423434>

14/ 4 Shepherds Hill Road, Bedford Park

<u>APPROXIMATE ESTIMATED AREA</u>	
Living	65.1
Porch	9.0
<hr/>	
TOTAL	74.1 sqm. app.

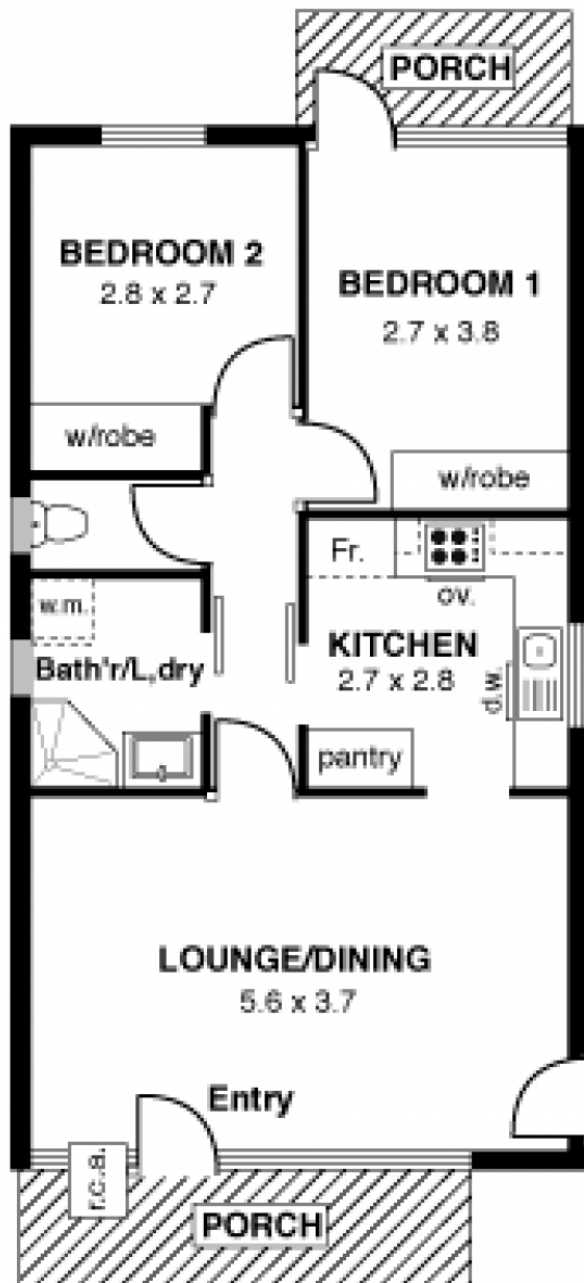

Every care has been taken to verify the correctness of areas and details used in this leaflet. However no warranty or representative is given or made as to the correctness of information supplied, and neither the owners nor the agent can accept responsibility for errors or omissions.

Imaging House Advertising, 168 Halifax Street, Adelaide 5000