

MAGAIN



5/44 Whitmore Square ADELAIDE SA

2 🏠 1 🚗 1 🚗

City Realty is pleased to bring you this wonderful opportunity to secure yourself a tightly held home and add your very own eco-friendly footprint in the Architecturally designed, Eco Friendly and Award-Winning Whitmore Square apartments.

Type : Townhouse
Price : \$ 502,100
Building Size : 110 sqm
View : <https://www.magain.com.au/property/54-4-whitmore-square-adelaide-sa/8423465>

Nestled on the edge of Whitmore Square and in the same complex as one of the best and most trendy cafe's in Adelaide in 'Troppo', this townhouse in the sky offers a refreshing point of difference with its earthy style and materials, split level living and Eco-Friendly features which together meld perfectly to create a sense of 'home' and pride in where you live.

Step out your front door and take a truly short stroll to the

[For full version visit the website](#)

<https://www.magain.com.au>
Magain Real Estate

765 Marion Road Ascot Park SA
08 8277 1777



C|R

5/42-56 WHITMORE SQUARE, ADELAIDE SA 5000

92.30 M²
INTERNAL AREA

17.40 M²
BALCONY

109.70 M²
GRAND TOTAL

THE FLOOR PLAN IS FOR ILLUSTRATION PURPOSE ONLY. MEASUREMENTS ARE APPROXIMATE AND INTERNAL. NOT TO SCALE © BREP

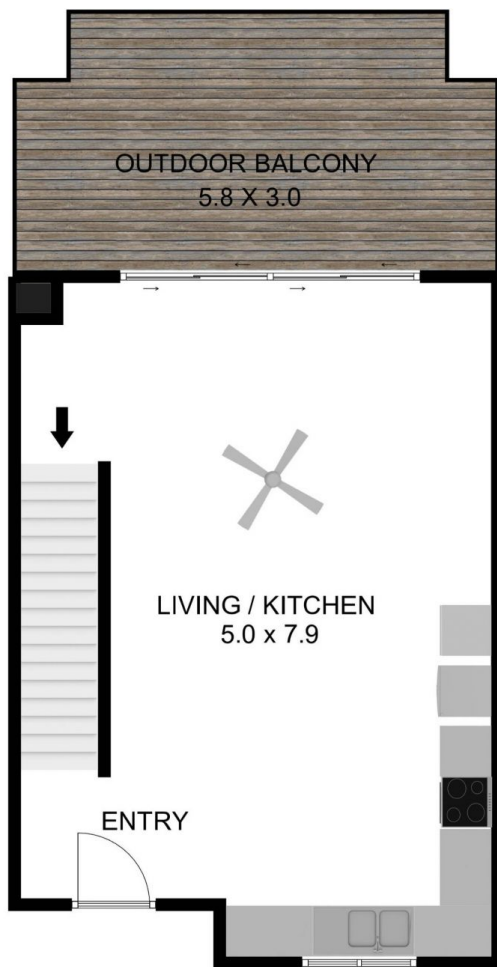

ENTRY LEVEL

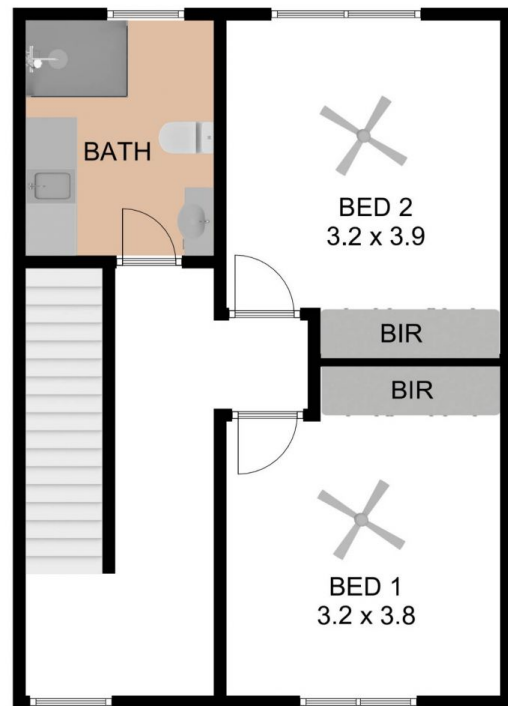

FIRST FLOOR

C|R

5/42-56 WHITMORE SQUARE, ADELAIDE SA 5000

92.30 M²
INTERNAL AREA

17.40 M²
BALCONY

109.70 M²
GRAND TOTAL