



MAGAIN



20/422-440 Pulteney Street ADELAIDE SA

2  1  1 

A rare opportunity to live to in a well known location, in a small apartment complex, with views of Hurtle Square and in walking distance from the parklands, cafes and restaurants.

Type : Apartment
View : <https://www.magain.com.au/property/20422440-pulteney-street-adelaide-sa/8423520>

Why you will love this property:

- 2 bedroom apartment, master with built-in-robe
- Huge balcony with views of Hurtle Square
- Open plan living area with reverse cycle split system and floating floor boards
- Kitchen with ample cupboard space
- Extra study alcove which could be used as a third bedroom
- Bathroom with bath and internal laundry
- New Carpets in the bedrooms

[For full version visit the website](#)

<https://www.magain.com.au>
Magain Real Estate

765 Marion Road Ascot Park SA
08 8277 1777

Area	M ²
Living	84.78
Balcony	17.21
Total Approx	101.99

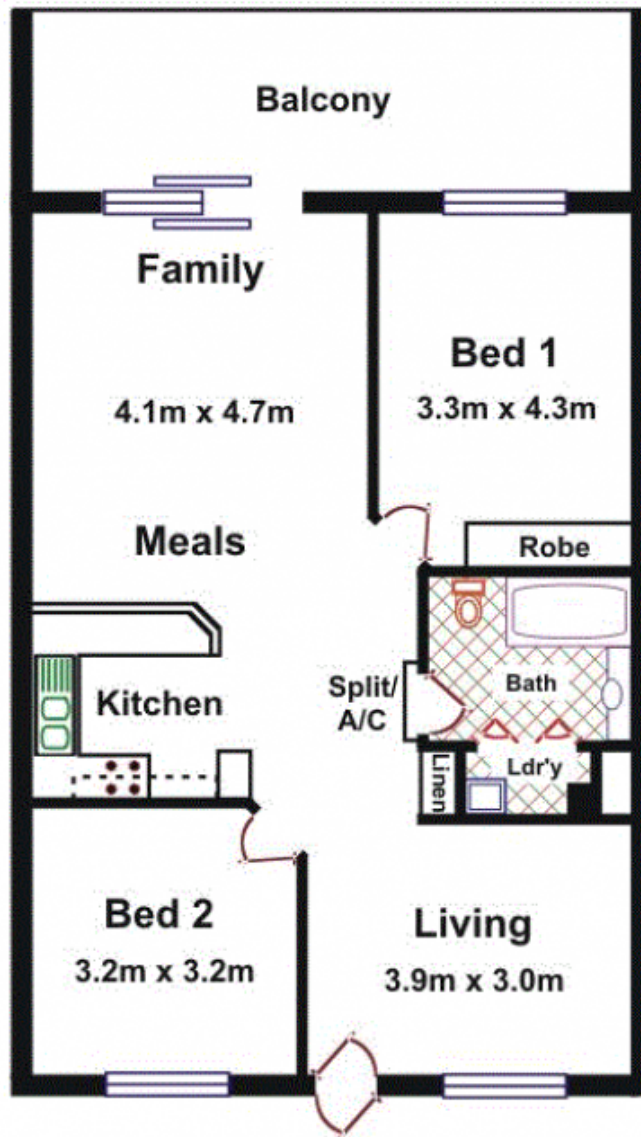

Secure Parking

Please Note: Every care has been taken to verify the correctness of the areas and details used in this leaflet. No warranty or representation is given or made as to the correctness of the information supplied and neither the owners, illustrator nor the Agents can accept responsibility for errors or omissions. The sketch is for illustration purposes only and intending purchasers should satisfy themselves independently regarding sizes, layout and location of the property. Please check with local council that all structures are approved by council.