

MAGAIN



447 Goodwood Road WESTBOURNE PARK SA

4  1  2 

BEAUTIFUL BUNGALOW- IMMACULATE!

This appealing character home is in pristine condition, enhanced by its many character features including ornate corning & ceiling roses, lead light windows, stunning wooden fretwork & picture rails with polished floorboards throughout. Ideally located on a perfect sized corner allotment (661sqm) approx with the bonus of side access onto quiet Constance Street.

The Why To Buy :-

Versatile floorplan incorporating

4/5 Large bedrooms + study

Rear extension with updated kitchen & meals/family area

Separate dining or study area

Ducted zoned reverse cycle air conditioning

Alarm system, window locks & sensor lights

Type : House

Building Size : 194 sqm

Land Size : 661 sqm

View : <https://www.magain.com.au/property/447-goodwood-road-westbourne-park-sa/8423595>

[For full version visit the website](https://www.magain.com.au)

<https://www.magain.com.au>
Magain Real Estate

765 Marion Road Ascot Park SA
08 8277 1777

447 Goodwood Road, Westbourne Park

APPROXIMATE ESTIMATED

Living	157.8
Verandah	36.7

TOTAL 194.5 sqm. app.

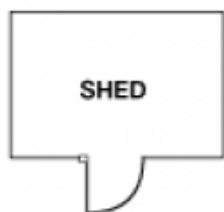

air con. outlets

Every care has been taken to verify the correctness of areas and details used in this leaflet. However no warranty or representative is given or made as to the correctness of information supplied, and neither the owners nor the agent can accept responsibility for errors or omissions.

Imaging House Advertising, 168 Halifax Street, Adelaide 5000

