

MAGAIN



35 Allen Avenue BROOKLYN PARK SA

3  **1**  **3** 

Sitting on approx 655 sqm of land this beautifully maintained solid family home is located in a quiet, tree lined cul-de-sac between the city and the sea.

Type : House

View : <https://www.magain.com.au/property/35-allen-avenue-brooklyn-park-sa/8423679>

The perfect family home comprises of 3 spacious bedrooms, eye catching timber kitchen with gas appliances and separate living areas.

Features include:

- 3 Spacious bedrooms, 2 with BIRs
- Timber kitchen with stainless steel gas appliances
- Floorboards throughout living area
- Plenty of natural light throughout
- R/C wall unit
- Bathroom with separate bath and shower

[For full version visit the website](#)

<https://www.magain.com.au>
Magain Real Estate

765 Marion Road Ascot Park SA
08 8277 1777

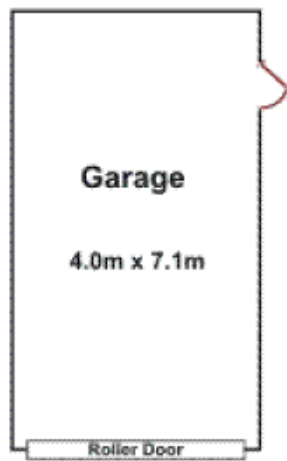

Area	M ²
Living	103.56
Verandah	33.58
Total Approx	137.14

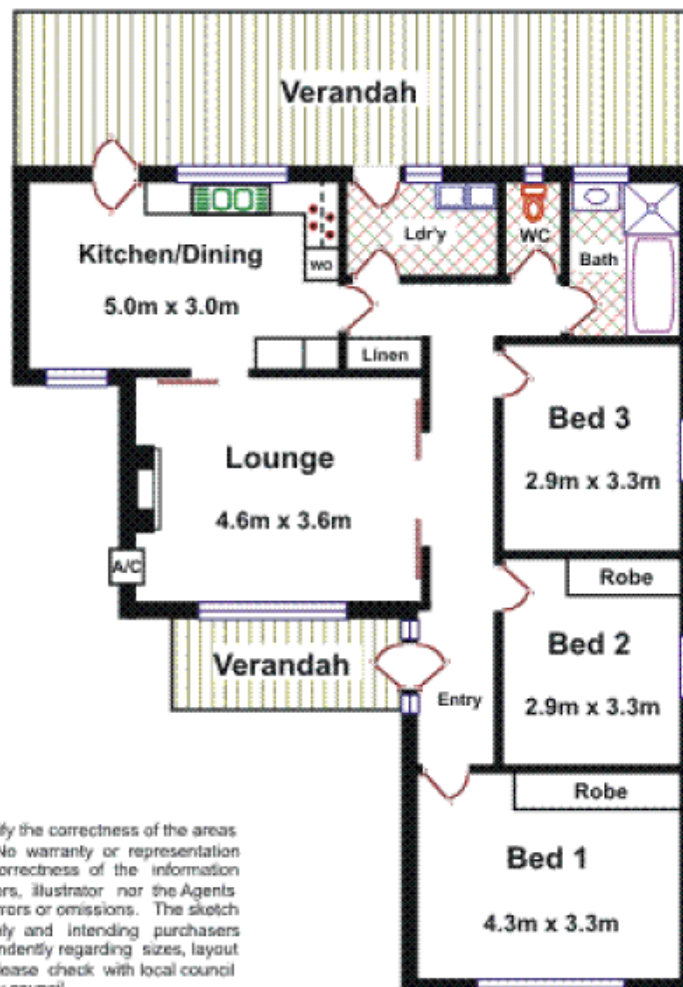

Please Note:
 Every care has been taken to verify the correctness of the areas and details used in this leaflet. No warranty or representation is given or made as to the correctness of the information supplied and neither the owners, illustrator nor the Agents can accept responsibility for errors or omissions. The sketch is for illustration purposes only and intending purchasers should satisfy themselves independently regarding sizes, layout and location of the property. Please check with local council that all structures are approved by council.

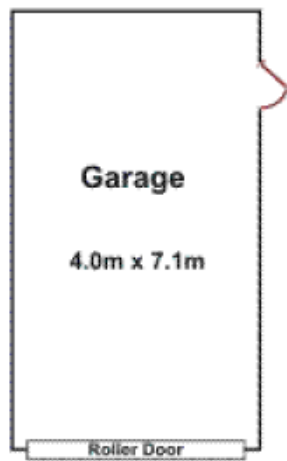

Area	M ²
Living	103.56
Verandah	33.58
Total Approx	137.14

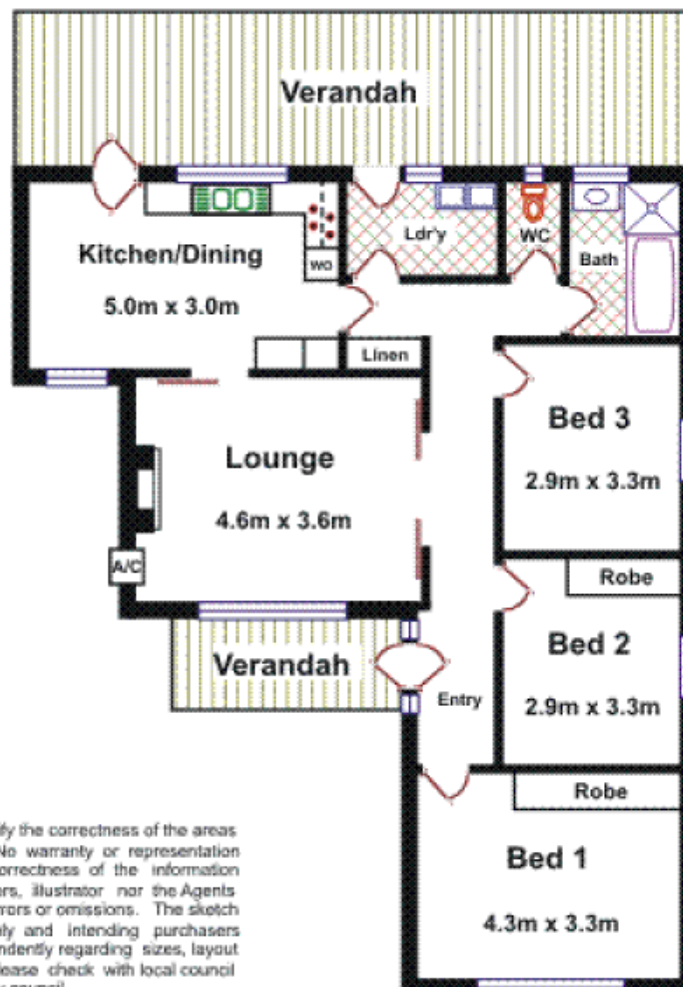

Please Note:
 Every care has been taken to verify the correctness of the areas and details used in this leaflet. No warranty or representation is given or made as to the correctness of the information supplied and neither the owners, illustrator nor the Agents can accept responsibility for errors or omissions. The sketch is for illustration purposes only and intending purchasers should satisfy themselves independently regarding sizes, layout and location of the property. Please check with local council that all structures are approved by council.