



MAGAIN



105/211 Grenfell Street ADELAIDE SA

2  2  1 

Located in the popular East End district, this chic apartment not only offers a home but a lifestyle; just minutes walk from Rundle Mall and Adelaide University and surrounded by cafes, restaurants and parks.

Type : Unit
View : <https://www.magain.com.au/property/105211-grenfell-street-adelaide-sa/8423734>

The open plan living, dining and kitchen area is perfect for entertaining with large windows creating a bright ambiance. The open plan living area leads on to your large north facing balcony, the perfect place to watch Adelaides vibrant city life pass by.

Two spacious bedrooms are filled with natural light from the floor to ceiling windows, both come with built in robes and the master bedroom being serviced by the sparkling ensuite.

[For full version visit the website](#)

<https://www.magain.com.au>
Magain Real Estate

765 Marion Road Ascot Park SA
08 8277 1777

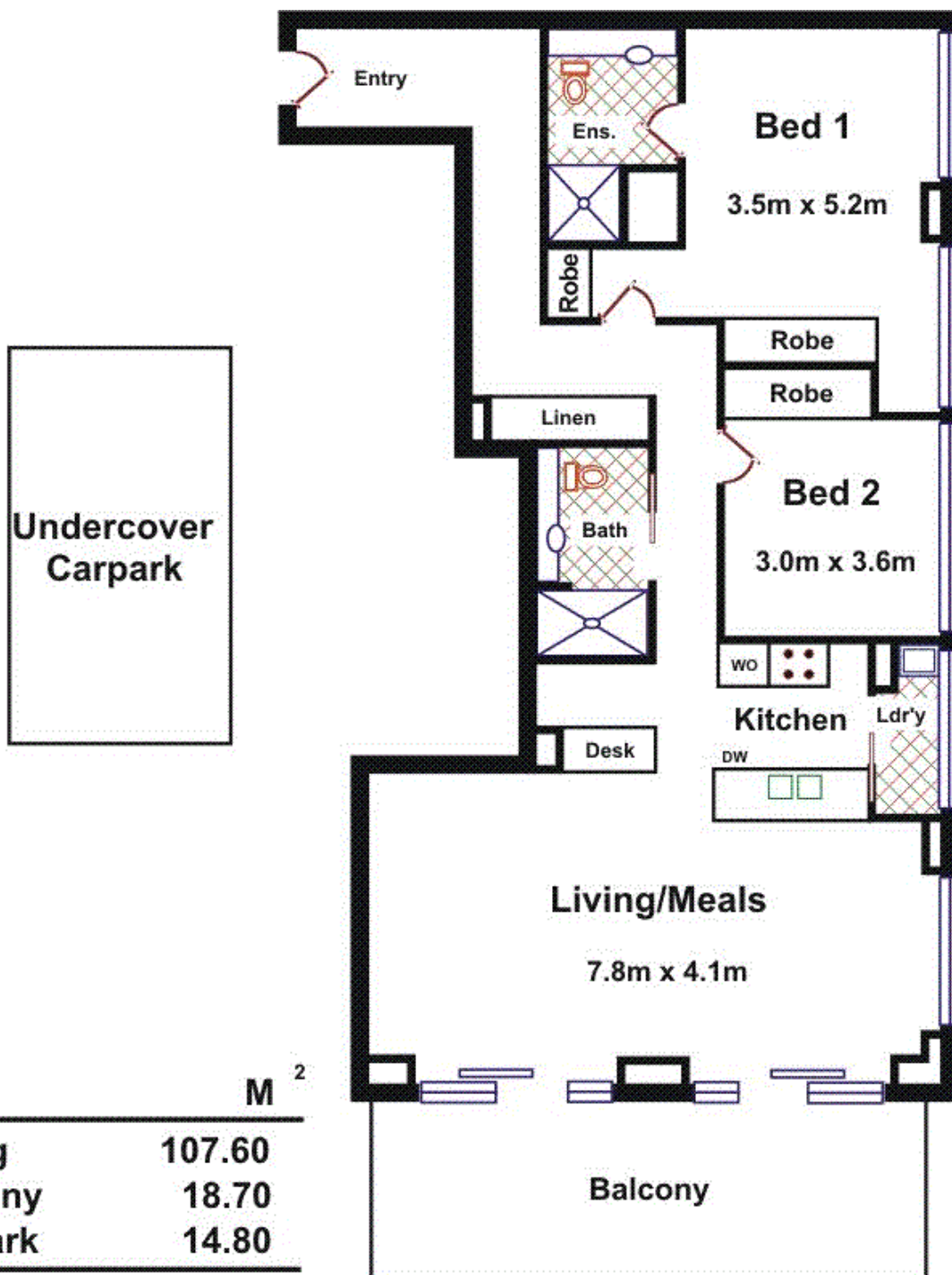

Area	M ²
Living	107.60
Balcony	18.70
Carpark	14.80
Total Approx	141.10

Please Note: Every care has been taken to verify the correctness of the areas and details used in this leaflet. No warranty or representation is given or made as to the correctness of the information supplied and neither the owners, illustrator nor the Agents can accept responsibility for errors or omissions. The sketch is for illustration purposes only and intending purchasers should satisfy themselves independently regarding sizes, layout and location of the property. Please check with local council that all structures are approved by council.