

MAGAIN



6/26 South Terrace ADELAIDE SA

1 1 1

This well presented studio apartment is ideally positioned across from the South Parklands and will appeal to first home buyers or investors.

Type : Unit
View : <https://www.magain.com.au/property/626-south-terrace-adelaide-sa/8423756>

Why you will love this property:

- Light and bright open plan bedroom and living
- Built in wardrobe in the bedroom/living
- Kitchen with plenty of cupboard space
- Bathroom with Internal laundry
- Ground floor unit
- Secure access to building
- 1 Car park
- Currently rented at \$160 per week on a periodic lease

This little cracker is perfectly positioned close to Parklands,

[For full version visit the website](#)

<https://www.magain.com.au>
Magain Real Estate

765 Marion Road Ascot Park SA
08 8277 1777

Area	M ²
Living	29.65
Balcony	5.96
Total Approx	35.61

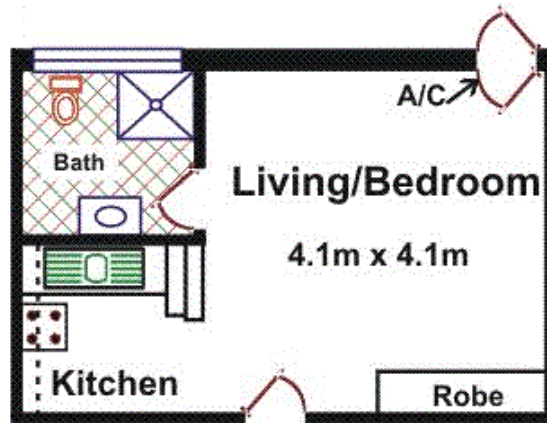

Please Note: Every care has been taken to verify the correctness of the areas and details used in this leaflet. No warranty or representation is given or made as to the correctness of the information supplied and neither the owners, illustrator nor the Agents can accept responsibility for errors or omissions. The sketch is for illustration purposes only and intending purchasers should satisfy themselves independently regarding sizes, layout and location of the property. Please check with local council that all structures are approved by council.