

# MAGAIN



**605/39 Grenfell Street ADELAIDE SA**

**2**  **2** 

Located right in the heart of the CBD, enjoy cosmopolitan city living with Rundle Mall, Rundle Street, Adelaide Universitys, TAFE, Adelaide Central Markets plus so much more only walking distance away! The ideal city pad for students, city professionals and investors alike!

**Type** : Apartment

**View** : <https://www.magain.com.au/property/60539-grenfell-street-adelaide-sa/8423827>

This generous 2 bedroom apartment is not one to miss! It has been immaculately maintained by the current owners and boasts stunning leafy outlooks, spacious light filled living areas plus a simple lockup and leave lifestyle.

Further features include:

- 2 Spacious bedrooms, both with BIRs and ensuites
- Main bedroom features direct balcony access with a

[For full version visit the website](https://www.magain.com.au/property/60539-grenfell-street-adelaide-sa/8423827)

<https://www.magain.com.au>  
Magain Real Estate

765 Marion Road Ascot Park SA  
08 8277 1777

Living Area		74.42sqm
Balcony		8.46sqm
Total	Approx.	82.88sqm

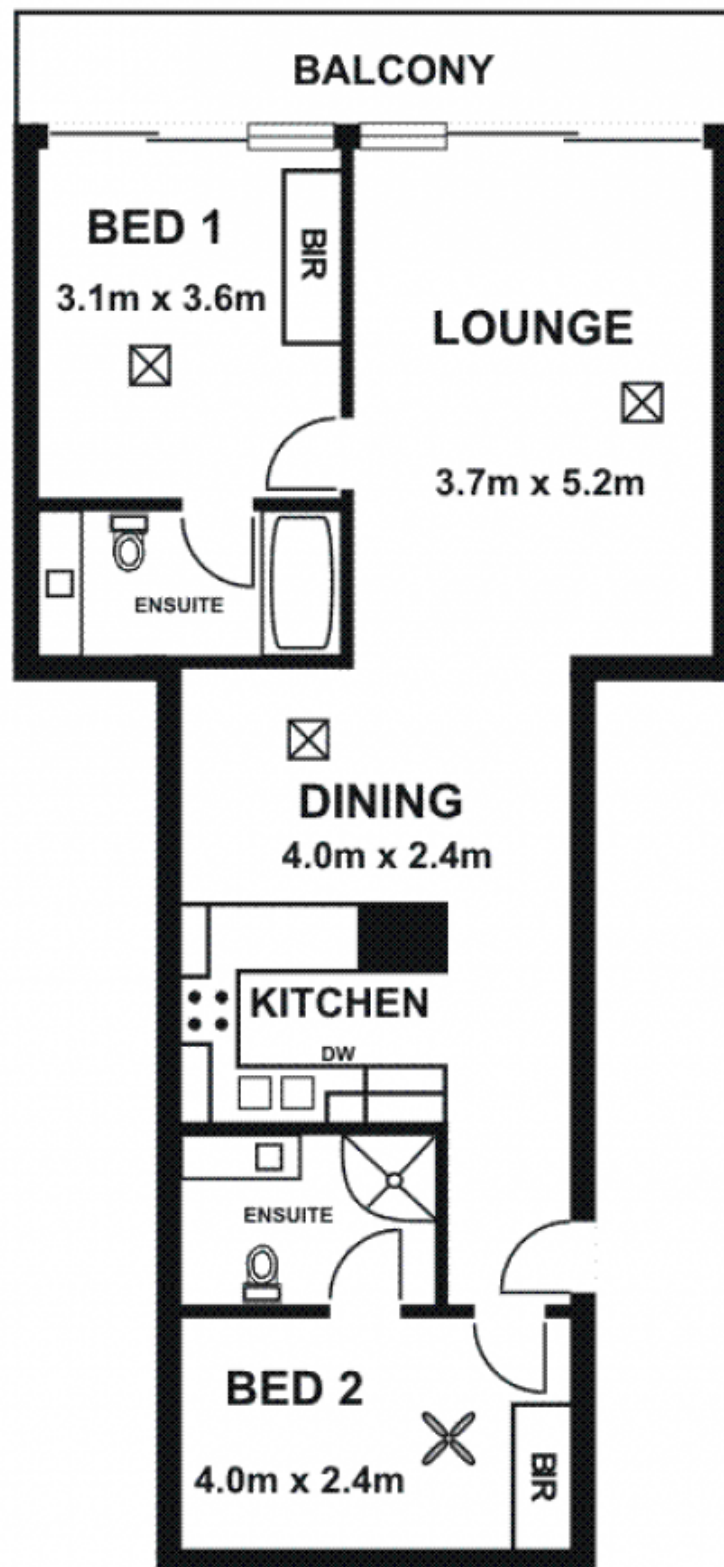

**Please Note:** Every care has been taken to verify the correctness of the areas and details used in this leaflet. No warranty or representation is given or made as to the correctness of the information supplied and neither the owners, illustrator nor the Agent accept responsibility for errors or omissions. The sketch is for illustration purposes only and intending purchasers should satisfy themselves independently regarding sizes, layout and location of the property. Please check with local council that all structures are approved by council.