

MAGAIN



14 Pridham Court ABERFOYLE PARK SA

4  2  2 

Contact Travis Denham or Craig Thomson for viewing times.

Open cancelled due to being under contract.

This superb family home is situated on a grand allotment of approx. 1140sqm, set on a quiet no through road and backing onto a gorgeous reserve. Ideal for the growing family as it provides plenty of space for the kids to run around. The home is set within close proximity to local shops, quality schools, public transport, parks, trails and much more!

The spacious home features 4 bedrooms throughout, each fitted with quality carpet flooring and built in robes. The

[For full version visit the website](https://www.magain.com.au/property/14-pridham-court-aberfoyle-park-sa/842408)

Type : House
Building Size : 22 sqm
Land Size : 1140 sqm
View : <https://www.magain.com.au/property/14-pridham-court-aberfoyle-park-sa/842408>
6



Travis Denham
08 8398 1494

14 Pridham Court Aberfoyle Park, South Australia.

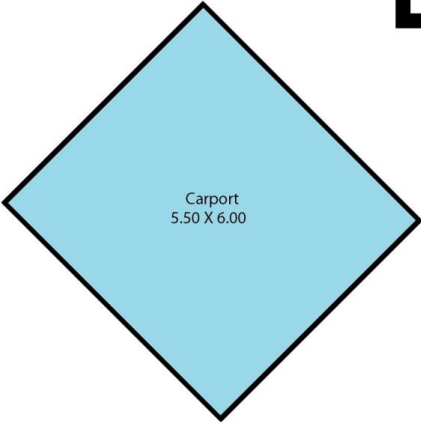

Picture intended as a reference only. Any specific measurements required should be obtained by an independent surveyor.