

# MAGAIN



## 3 Redlac Road MORPHETT VALE SA

3  1  1 

Contact Travis Denham or Craig Thomson for viewing times.

This fantastic home is situated on a generous allotment of approximately 760sqm, ideally set on a quiet street close to local amenities including shops, quality schools, public transport, access to the southern expressway and more. It is a must-see for first home buyers, downsizers or those seeking a superb investment opportunity.

The kitchen features quality appliances including electric cook-top, oven and dishwasher. Equipped with ample cupboard storage and built-in pantry. The spacious living area at the front of the home is complemented by polished timber flooring.

[For full version visit the website](https://www.magain.com.au/property/3-redlac-road-morphett-vale-sa/8424176)

**Type** : House  
**Building Size** : 13 sqm  
**Land Size** : 760 sqm  
**View** : <https://www.magain.com.au/property/3-redlac-road-morphett-vale-sa/8424176>



**Travis Denham**  
08 8398 1494

3 Redlac Road Morphett Vale, South Australia

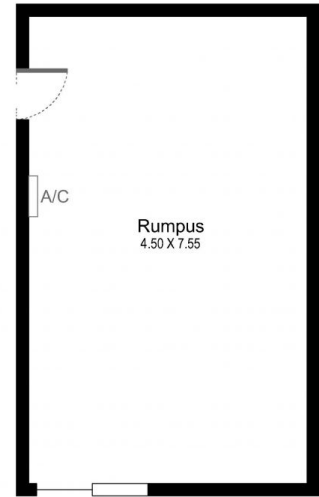

Picture intended as a reference only. Any specific measurements required should be obtained by an independent surveyor.