

MAGAIN



52 Patta Avenue LIGHTSVIEW SA

3  2  1 

Nestled within the stunning suburb of Lightsview is this brand new, three-story residence that boasts grand designs and qualities. This home will certainly gain the attention of keen buyers seeking a luxurious premises, with low-maintenance, in an incredible lifestyle location. With genuine street appeal, a spacious living area and modern kitchen, solar panels for energy efficiency, a secure garage with internal access and two separate balconies that offer incredible views - this property will not be on the market for long!

Stepping into the home you will notice the top quality features that this home includes, from the quality flooring and carpets to the energy-saving downlights throughout. The bottom floor of the home comprises of bedroom 2

[For full version visit the website](https://www.magain.com.au/property/52-patta-avenue-lightsview-sa/8424600)

Type : House
Building Size : 21 sqm
Land Size : 79 sqm
View : <https://www.magain.com.au/property/52-patta-avenue-lightsview-sa/8424600>



Travis Denham
08 8398 1494

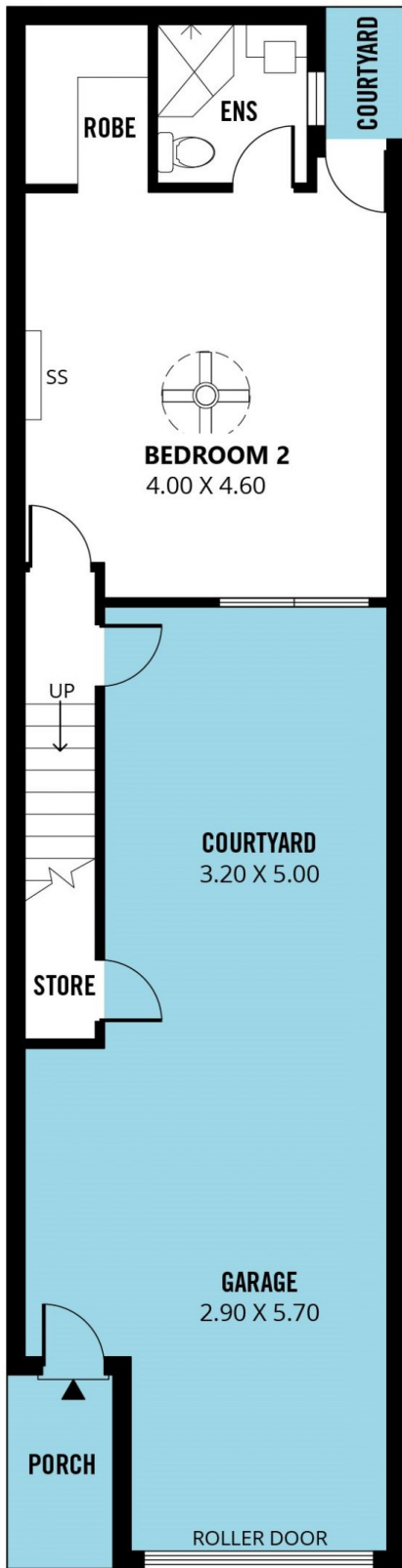

GROUND FLOOR

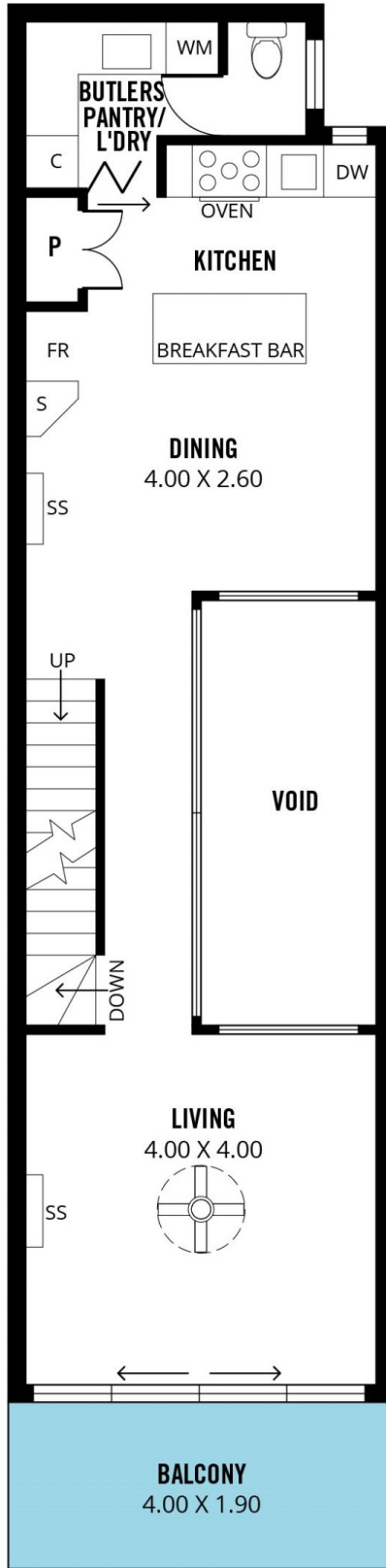

FIRST FLOOR

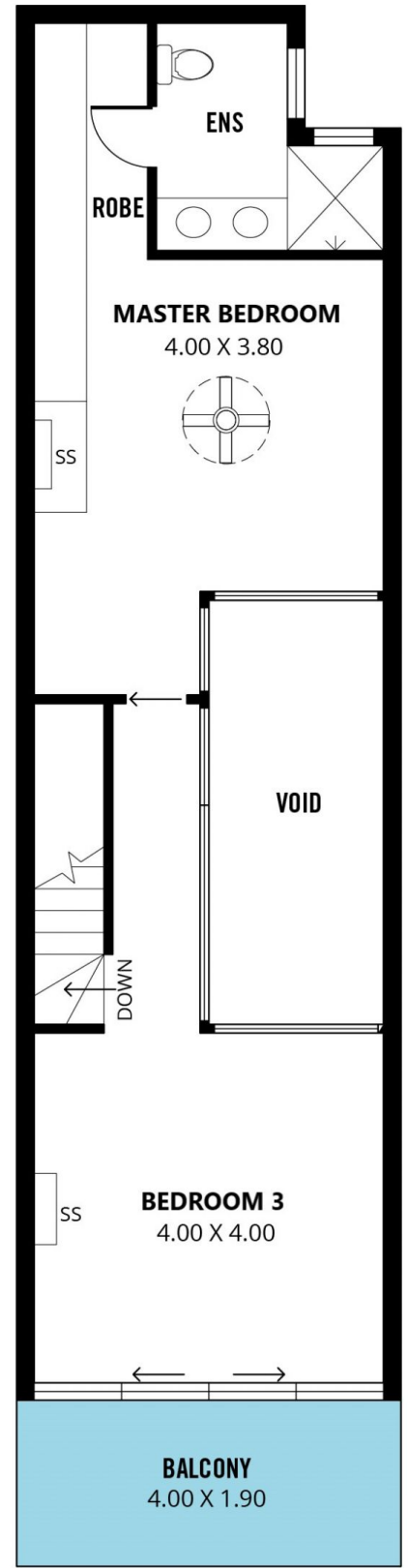

SECOND FLOOR

Scale in metres. This drawing is for illustration purposes only. All measurements are approximate and details intended to be relied upon should be independently verified. Produced by **The Fotobase Group**