

# MAGAIN



6 David Terrace MORPHETT VALE SA

4 2 3

Contact Craig Thomson for viewing times.

This fantastic home is situated on a generous corner allotment of approximately 910sqm, ideally set on a quiet street close to local amenities including shops, quality schools, public transport, parks and more. The spacious home also features a separate Granny Flat, complete with private access from Carolyn Crescent. Ideal for the largest of families, and those seeking a superb investment opportunity.

The kitchen is equipped with ample cupboard storage, built in pantry, electric cook-top and dishwasher. Leading through to the spacious dining and living areas at the front of the home.

[For full version visit the website](https://www.magain.com.au/property/6-david-terrace-morphett-vale-sa/8425580)

**Type** : House  
**Building Size** : 21 sqm  
**Land Size** : 910 sqm  
**View** : <https://www.magain.com.au/property/6-david-terrace-morphett-vale-sa/8425580>



**Craig Thomson**  
08 8366 2292

# 6 David Terrace Morphett Vale, South Australia

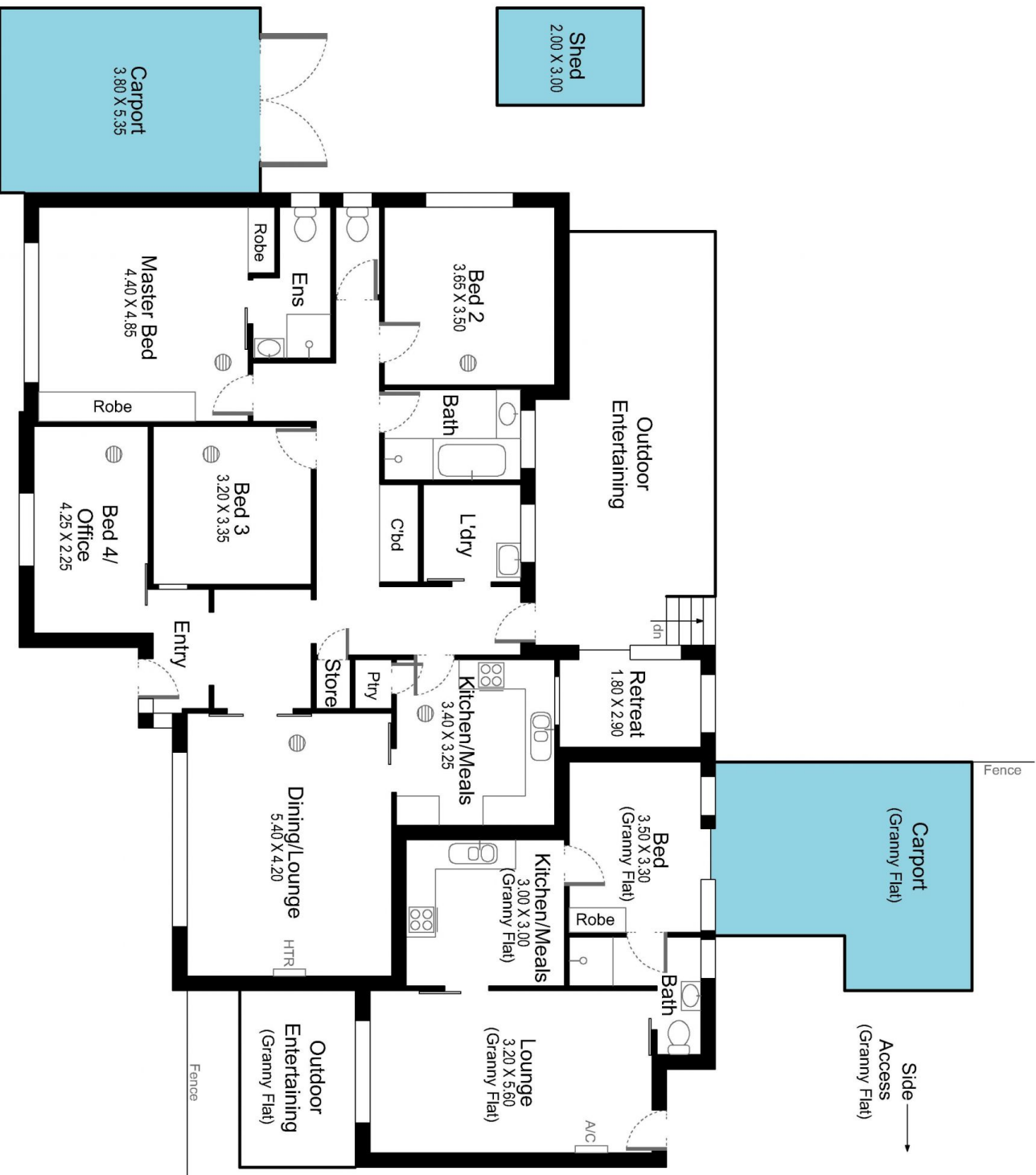

Picture intended as a reference only. Any specific measurements required should be obtained by an independent surveyor.