

# MAGAIN



23 Ellis Avenue MORPHETT VALE SA

3  1  4 

Contact Craig Thomson or Sheridan Anthony for viewing times.

This fantastic home is situated on a generous allotment of approximately 760sqm, ideally set on a quiet street close to local amenities including shops, quality schools, public transport, parks and more. It is an absolute must see for first home buyers, downsizers or those seeking a superb investment opportunity.

The updated kitchen features quality stainless steel appliances including gas cook-top and dishwasher. Equipped with ample cupboard storage, island bench, built in pantry and overlooks the meals and family area.

[For full version visit the website](https://www.magain.com.au/property/23-ellis-avenue-morphett-vale-sa/8425597)

**Type** : House  
**Building Size** : 12 sqm  
**Land Size** : 760 sqm  
**View** : <https://www.magain.com.au/property/23-ellis-avenue-morphett-vale-sa/8425597>



**Craig Thomson**  
08 8366 2292

23 Ellis Avenue Morphett Vale, South Australia

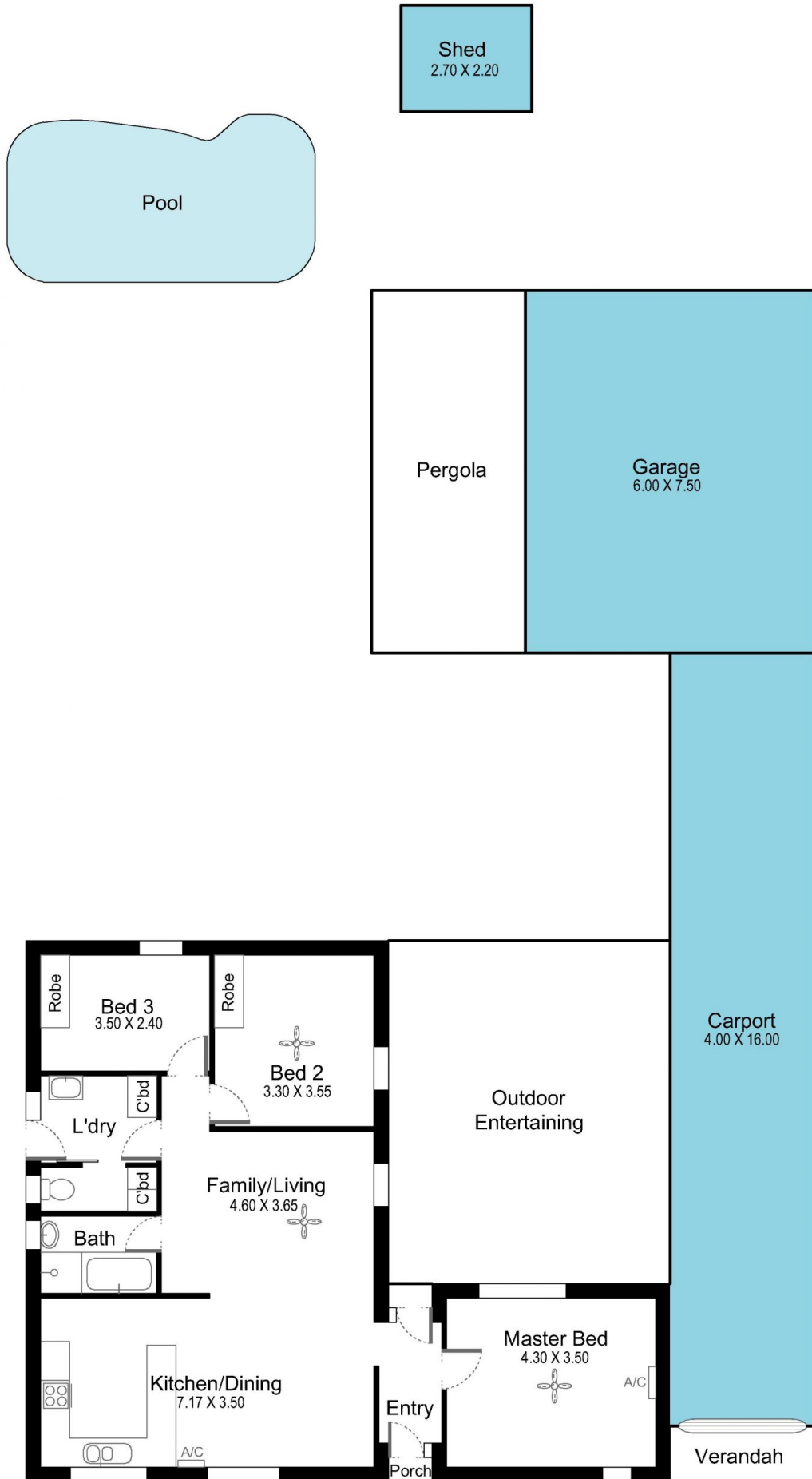

Picture intended as a reference only. Any specific measurements required should be obtained by an independent surveyor.