

# MAGAIN



## 12 Sanctuary Court MORPHETT VALE SA

3 2 3

Embrace no-fuss contemporary living with this modern three bedroom home, perfect for the first home buyer, downsizer or astute investor. Low maintenance living with all the modern conveniences, boasting easy access to shopping, schooling and transport with Christie Creek reserve and playground just a casual stroll away.

A sizeable family and meals space is joined by a well-appointed kitchen that creates a versatile space perfect for relaxing with the family, or entertaining. Pantry cupboard space, overhead cupboards, stainless appliances and ample bench space highlight a functional, modern kitchen with sliding door access to a great sized outdoor area.

**Type** : House  
**Building Size** : 13 sqm  
**Land Size** : 300 sqm  
**View** : <https://www.magain.com.au/property/12-sanctuary-court-morphett-vale-sa/8426642>

[For full version visit the website](https://www.magain.com.au)

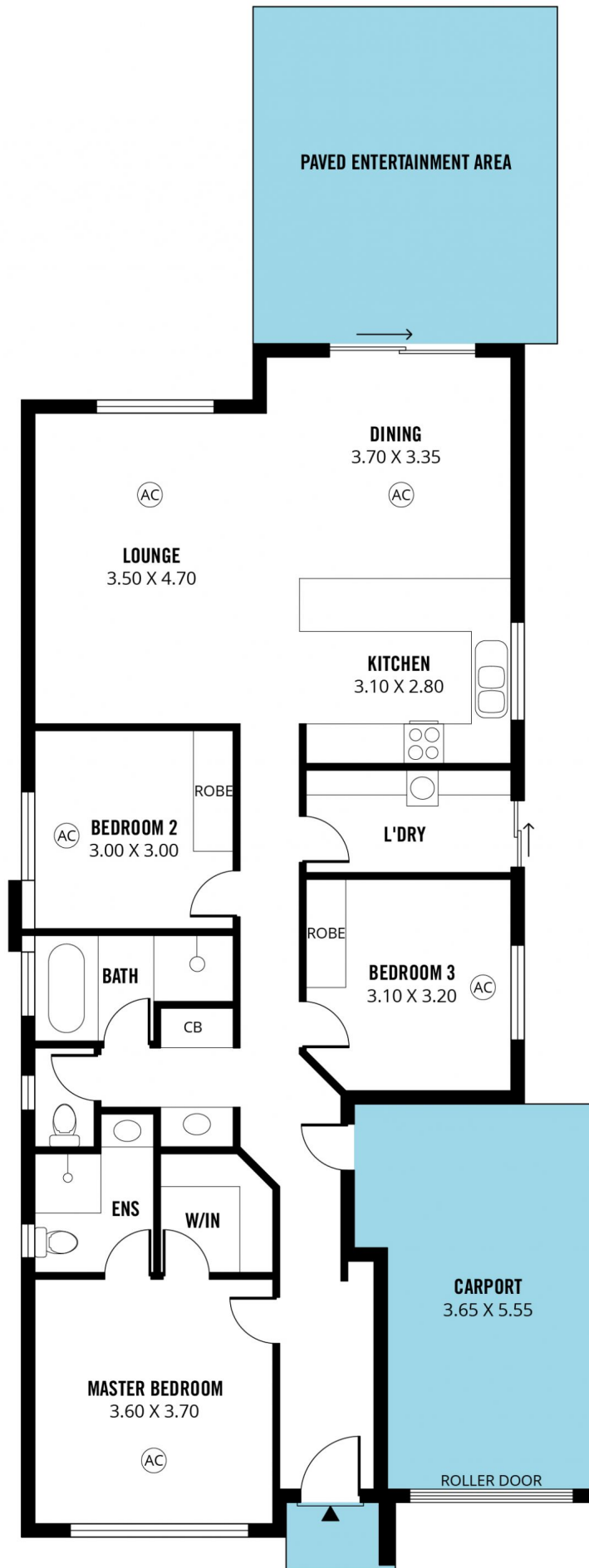

Scale in metres. This drawing is for illustration purposes only. All measurements are approximate and details intended to be relied upon should be independently verified. Produced by **The Fotobase Group**