



MAGAIN



65 Tobin Crescent WOODCROFT SA

4  2  6 

Please contact Robbie Leigh to discuss further.

Welcome to 65 Tobin Crescent Woodcroft. Positioned nicely on approx 725m², this lovely family home is the full package. Boasting four bedrooms, two bathrooms, two living areas, formal and informal dining areas, large outdoor entertaining area, huge triple garage and a workshop!
Be quick not to miss as it won't be on the market for long!

Highlights:

- Spacious master bedroom complete with ensuite bathroom and walk in robe
- Bedrooms 2, 3 complete with built in robes
- Spacious 4th bedroom/office with an abundance of

[For full version visit the website](https://www.magain.com.au/property/65-tobin-crescent-woodcroft-sa/8426849)

Type : House
Building Size : 24 sqm
Land Size : 725 sqm
View : <https://www.magain.com.au/property/65-tobin-crescent-woodcroft-sa/8426849>



Robbie Leigh
08 8366 2292

SHED
4.00 X 2.50

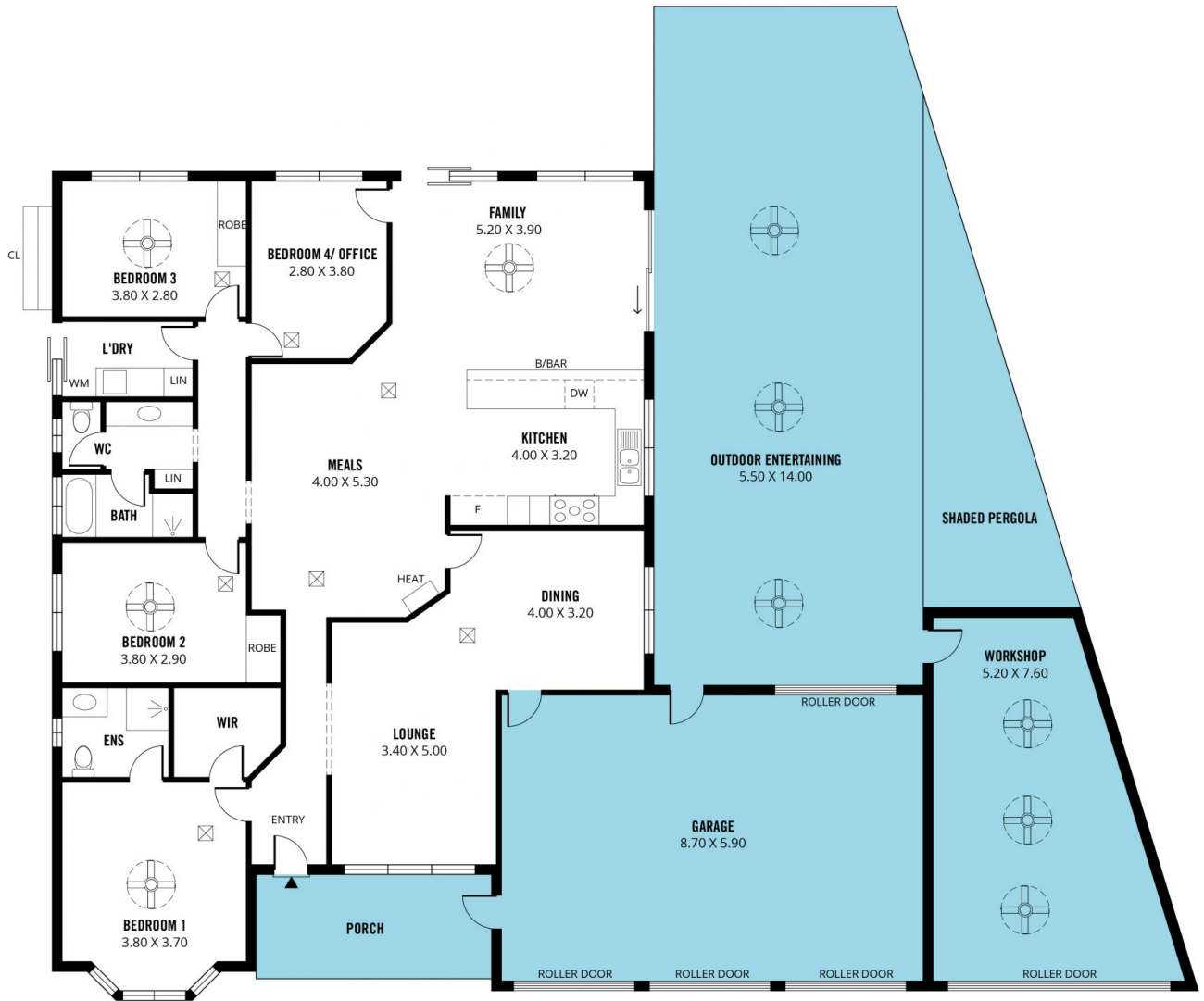

Scale in metres. This drawing is for illustration purposes only. All measurements are approximate and details intended to be relied upon should be independently verified.

Produced by **The Fotobase Group**