

# MAGAIN



## 5 8 Kitto Crescent ALDINGA BEACH SA

2  1  1 

Tucked away conveniently at the rear of the group, offering privacy and security, this elegant two-bedroom townhouse is suitable for a range of prospective buyers. Set in a small group of just six townhouses, it boasts a contemporary design and modern interior with a focus on a practical and convenient lifestyle.

Set over two levels with a well-designed layout, the downstairs offers a separate entry with beautiful gloss tile flooring, flowing all the way down the long hallway and opening into the spacious open plan living area. The gorgeous, up to date kitchen boasts stainless steel appliances including electric oven & gas cooktop, dishwasher plus loads of counter space and ample cupboard storage. The adjoining meals & living area is light

**Type** : Townhouse

**View** : <https://www.magain.com.au/property/5-8-kitto-crescent-aldinga-beach-sa/8427485>

[For full version visit the website](https://www.magain.com.au)

<https://www.magain.com.au>  
Magain Real Estate

Shop 2, 32 Saltfleet Street Port Noarlunga SA  
08 8382 0029

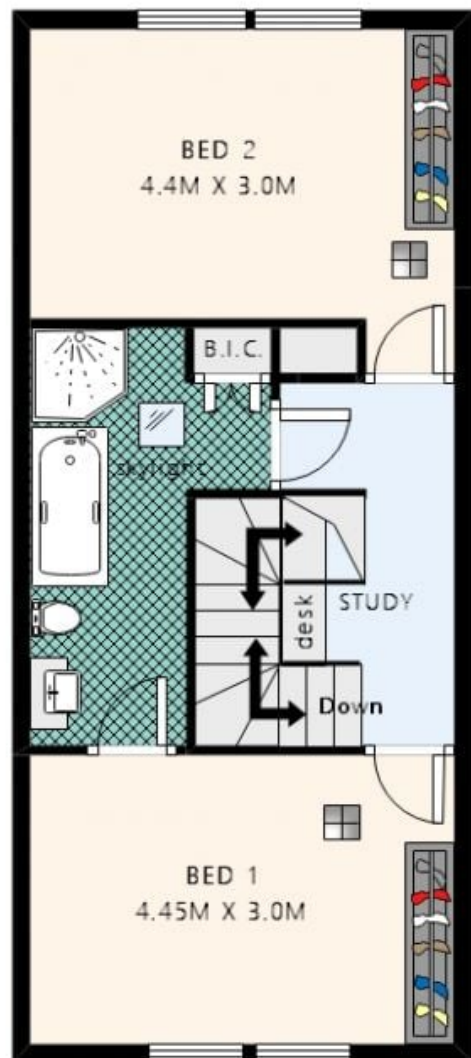

whilst every care was taken, these measurements & illustrations are approximate & cannot be relied upon for any purpose

UNIT 5 - 8 KITTO CRESCENT  
ALDINGA BEACH