

# MAGAIN



## 12 Kingston Circuit SEAFORD RISE SA

4  2  2 

A large family friendly home with street appeal in a quiet area amongst other quality homes and close to the Seaford Shopping Centre, the Southern Expressway, the Noarlunga Train Station and Seaford Schools.

**Type** : House

**View** : <https://www.magain.com.au/property/12-kingston-circuit-seaford-rise-sa/8427725>

Leisure and entertainment space is not compromised in this well designed property offering a formal lounge, carpeted and complimented with double windows creating a perfect space for entertaining guests. The open plan kitchen, dining and living with easy care tiled floors is light, bright and airy with double windows. This area allows leads to the large rumpus room with a big glass sliding door and access to the alfresco patio and garden. The kitchen boasts lots of storage cupboards, an island bench with double sink, stainless steel oven, gas hotplates, range

[For full version visit the website](#)

# 12 Kingston Circuit SEAFORD RISE

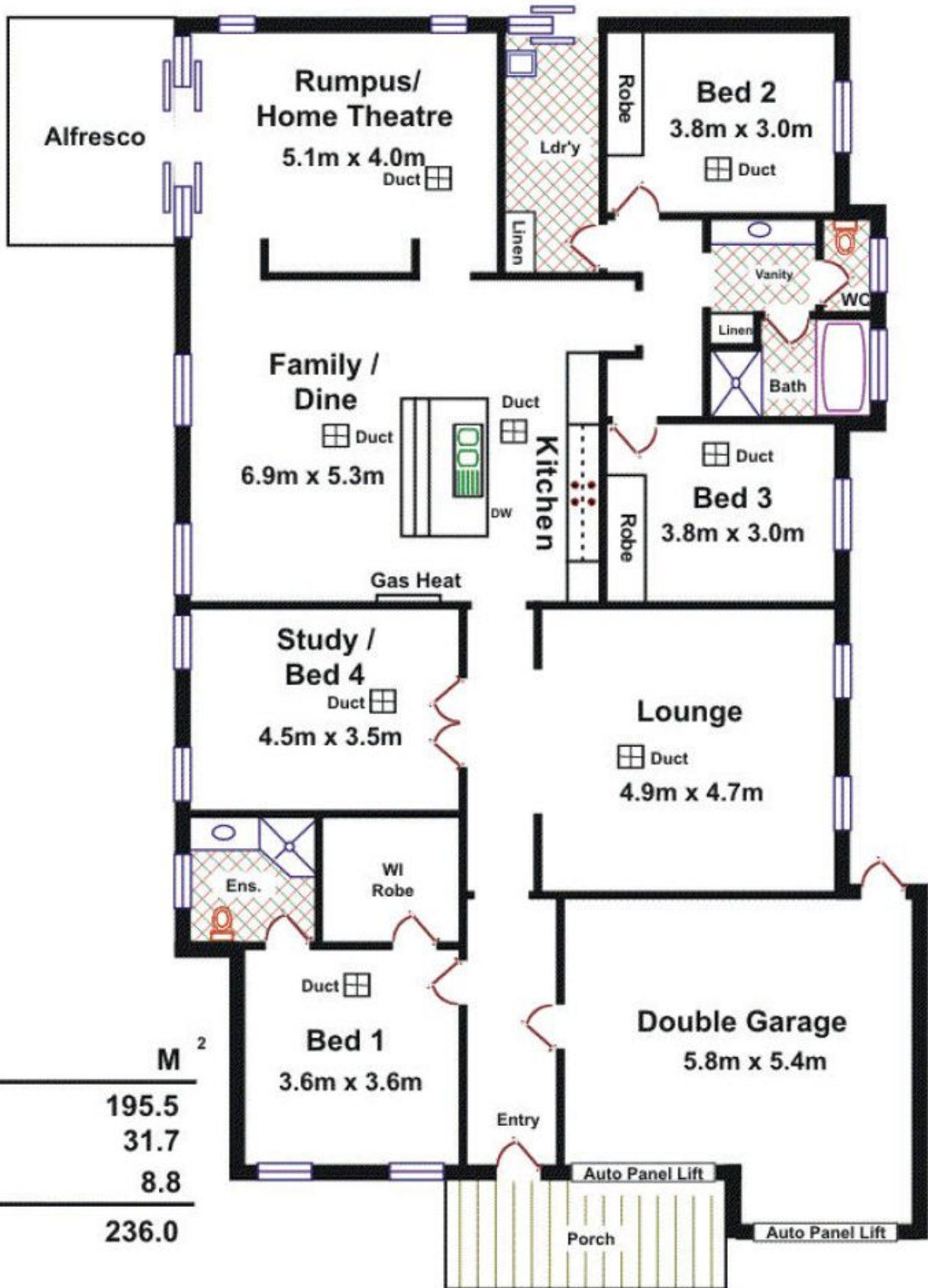

Area	M <sup>2</sup>
Living	195.5
Garage	31.7
Porch	8.8
<b>Total</b>	<b>236.0</b>

**Please Note:** Every care has been taken to verify the correctness of the areas and details used in this leaflet. However, the plan is not a surveyed plan and the dimensions given are estimates only. No warranty or representation is given or made as to the correctness of the information supplied and neither the owners nor the Agents can accept responsibility for errors or omissions. Please check with local council that all structures are approved by council.