

MAGAIN



3/162 Bradley Grove MITCHELL PARK SA

2  1  1 

Please contact Nathan Quarrell or Josh Morrison for viewing times.

This great townhouse would either make the perfect start for the first home owner or would be a great addition to the investors portfolio.

When entering the home a spacious living/dining/kitchen area greets you, which flows out to the back patio area. The laundry is separate and has its own downstairs WC.

Upstairs are 2 spacious bedrooms both with built in robes, and the bathroom complete with shower/bath, vanity and WC. The master bedroom is large and overlooks the front yard and the park and sporting fields across the road.

With enclosed courtyards at the front and rear of the home there is plenty of outdoor space. The back yard area has a pergola, secure carport parking for one car and a garden

Type : House
Building Size : 9 sqm
Land Size : 129 sqm
View : <https://www.magain.com.au/property/3162-bradley-grove-mitchell-park-sa/8429362>

[For full version visit the website](https://www.magain.com.au)

<https://www.magain.com.au>
Magain Real Estate

Shop 3, Happy Valley Shopping Centre, 50 Kenihans H
08 8322 6111

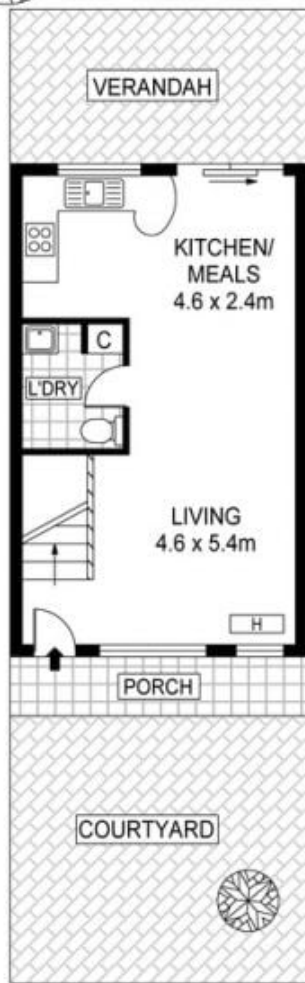
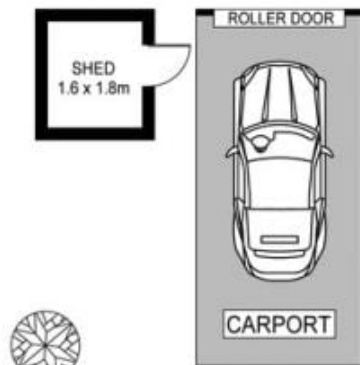

GROUND FLOOR

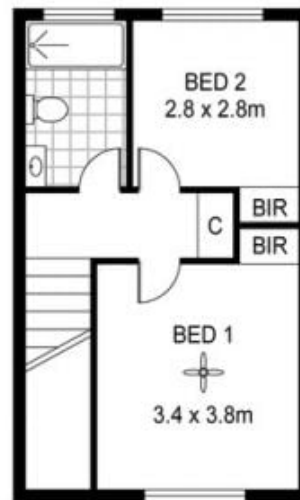

FIRST FLOOR



Scale in metres. Indicative only. Dimensions are approximate. All information contained herein is gathered from sources we believe to be reliable. However we cannot guarantee its accuracy and interested persons should rely on their own enquiries

INT : 72m²
SHED : 3m²

3/162 Bradley Grove, Mitchell Park