

# MAGAIN



10 Scenic Court CHANDLERS HILL SA

4 2 2

Simply stunning!

This impressive family home of generous proportions is on a huge 1100 sqm block and nestled in a quiet court, surrounded by other quality homes. Built in 2006, this Rosedale home incorporates all the 'I wants' along with a practical and spacious floorplan.

Featuring a split level design of 248 sqm that includes four bedrooms plus a study, master with ensuite and walk in robe, formal lounge/home theatre and a huge open plan family/meals/kitchen with floating floors and ducted reverse cycle heating and cooling for year round comfort.

Outside, listen to the kookaburras while you relax with friends on the extensive hardwood decking that offers fantastic 180 degree views of the hills to Glenelg and beyond! There is plenty of room for the kids to play and a

**Type** : House  
**Building Size** : 27 sqm  
**View** : <https://www.magain.com.au/property/10-scenic-court-chandlers-hill-sa/8430558>

[For full version visit the website](https://www.magain.com.au)

<https://www.magain.com.au>  
Magain Real Estate

Shop 3, Happy Valley Shopping Centre, 50 Kenihans H  
08 8322 6111

# 10 Scenic Court, Chandlers Hill

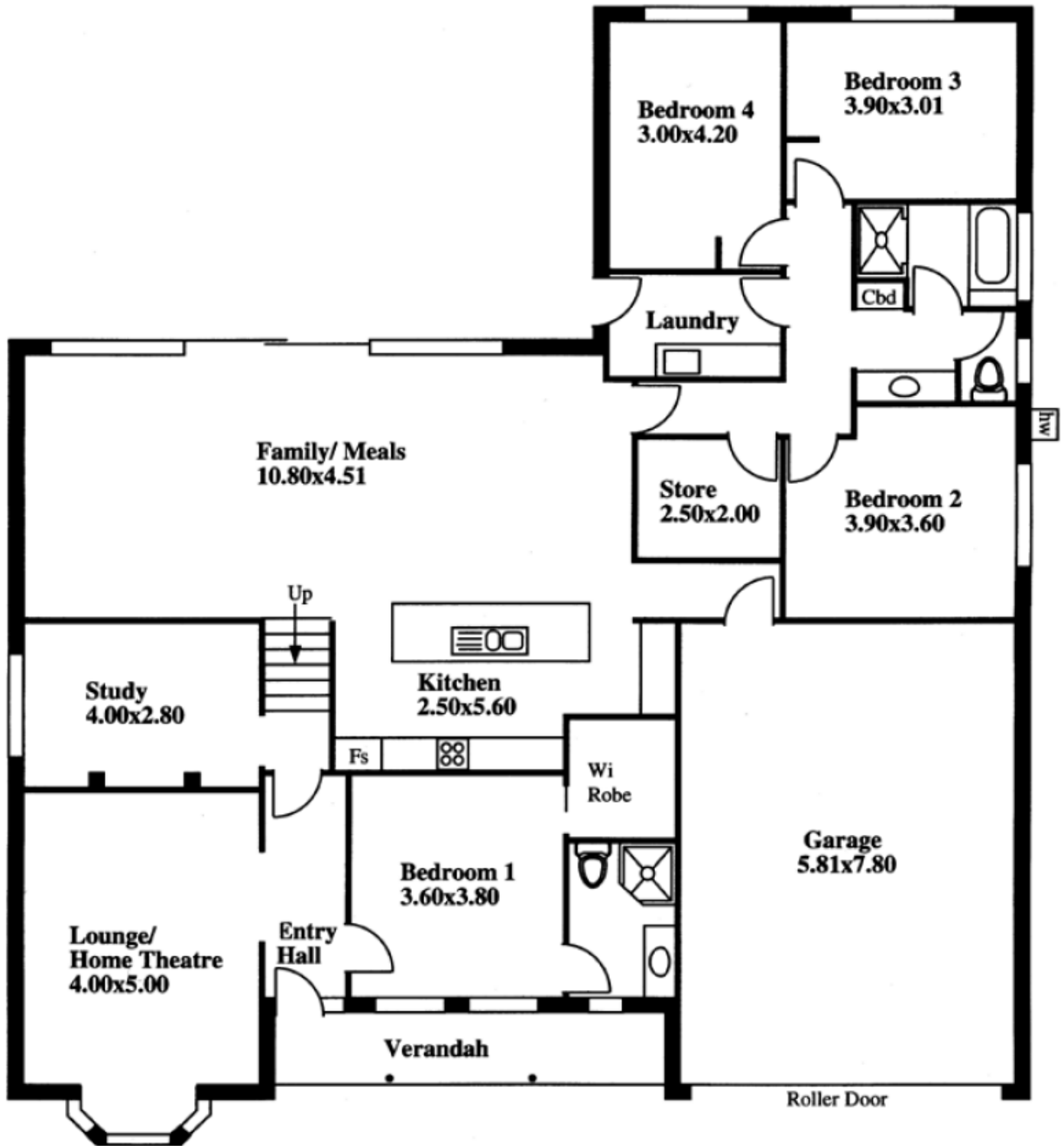

## ESTIMATE OF AREA

HOUSE 261.23 Square metres/ 28.08 Squares  
(Including Garage)

Desk Top Image (1009-19)

This drawing is for illustration purposes only  
(Drawing is not to scale)

The drawing and the information contained is not intended to be part of any contract. All measurements are approximate and details intended to be relied upon should be independently verified.