

MAGAIN



38-100 Pimpala Road MORPHETT VALE SA

3 1 1

Situated in the secure gated community of Castle Hill Estate is this beautiful 2002 built three bedroom courtyard home.

Inside you'll find a large lounge room, spacious kitchen with modern appliances, open dining area, three spacious bedrooms (the main with mirrored built in robe), all wrapped up in a sought after layout.

Outside there is a low maintenance yard with large carport and room for two cars undercover. The community is gated and very secure with automatic gates and a brilliant atmosphere.

Rental Estimate \$270 per week based on previous tenant

[For full version visit the website](https://www.magain.com.au/property/38-100-pimpala-road-morphett-vale-sa/8430706)

Type : House
Building Size : 11 sqm
View : <https://www.magain.com.au/property/38-100-pimpala-road-morphett-vale-sa/8430706>

38/100 Pimpala Road, MORPHETT VALE

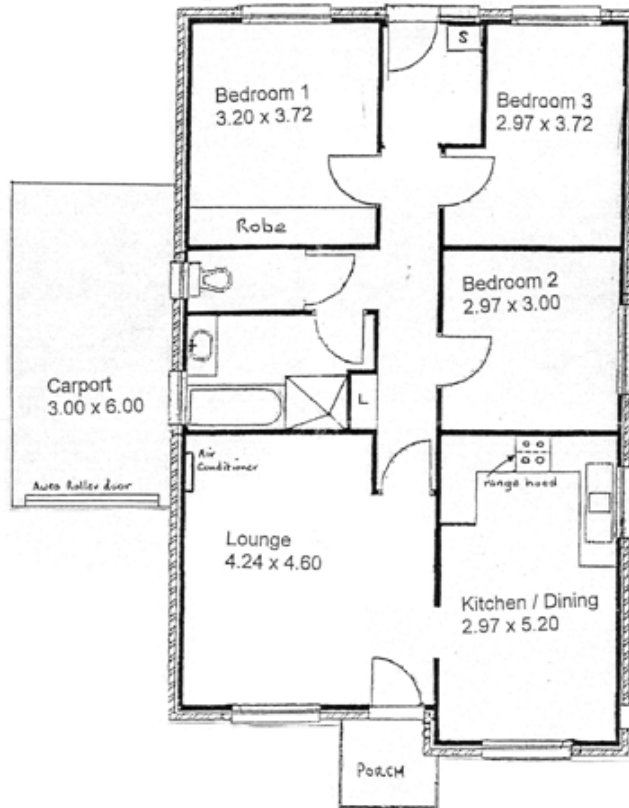

Disclaimer

Drawing is for illustration purposes only.
All measurements are approximate and details intended to be relied upon should be independently verified