

MAGAIN



11 Holmeswood Court ONKAPARINGA HILLS SA

6 2 2

Please contact Travis Denham today to discuss viewing times.

If you have a large family and require the space, comfort and quality that a good family home should have then look no further than this premium property. Boasting 6 good size bedrooms all with built in robes, that's right 6 dedicated bedrooms, not a study or converted dining room. This home is more than capable to house a busy modern day family.

As you enter the property you will be blown away by the size of the home. There is a large & spacious, sunken formal lounge at the front of the home and adjoins the dining area. The master suite is very spacious and includes

[For full version visit the website](https://www.magain.com.au/property/11-holmeswood-court-onkaparinga-hills-sa/8431207)

Type : House
Building Size : 24 sqm
View : <https://www.magain.com.au/property/11-holmeswood-court-onkaparinga-hills-sa/8431207>



Travis Denham
08 8398 1494

11 Holmeswood Court, Onkaparinga Hills

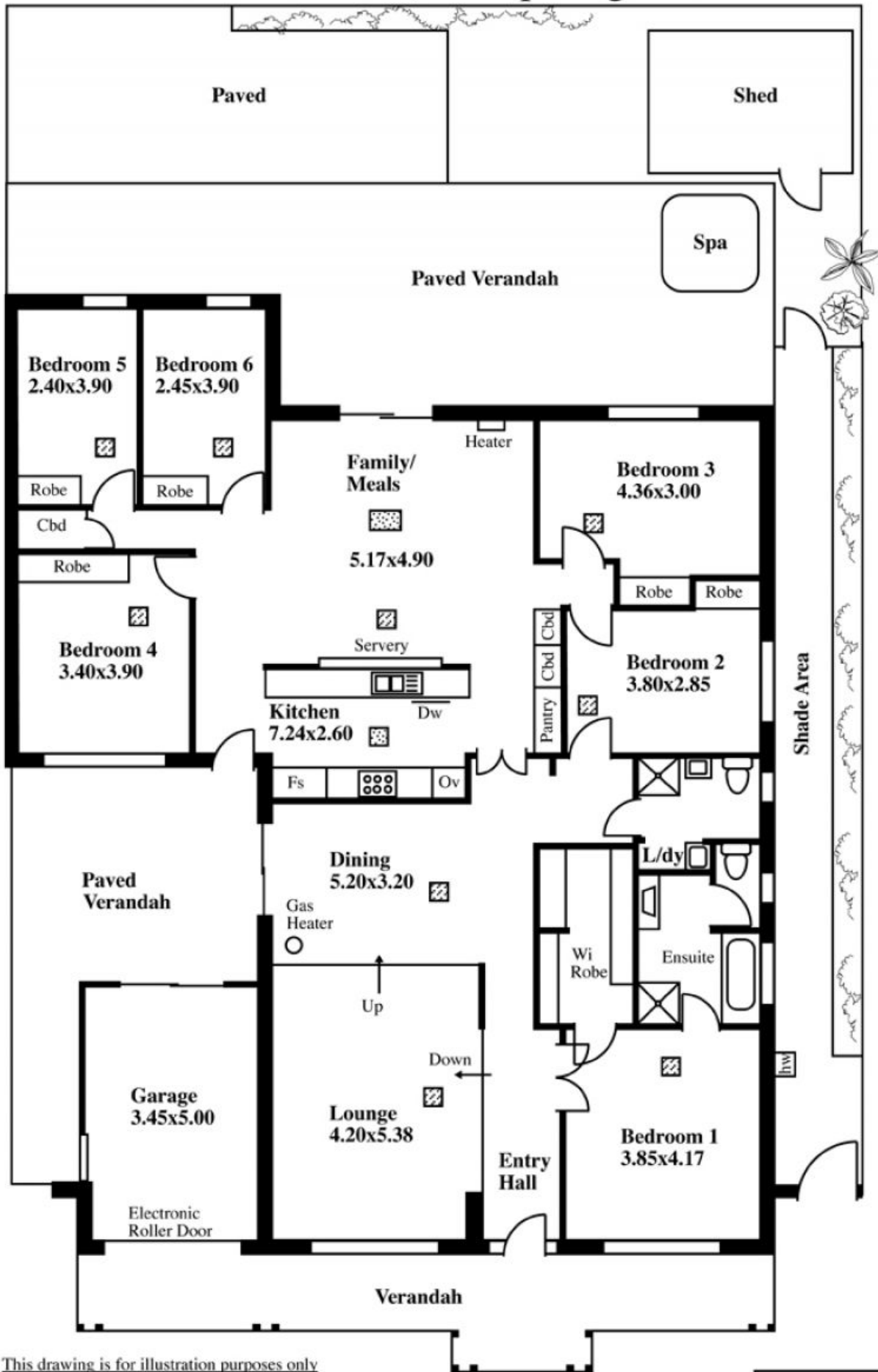



This drawing is for illustration purposes only
(Drawing is not to scale)

The drawing and the information contained is not intended to be part of any contract. All measurements are approximate and details intended to be relied upon should be independently verified.

Desk Top Image - (Y0713-112)

ESTIMATE OF LIVING AREA ONLY
214.88 Square metres/ 23.09 Squares
GARAGE 18.60 Square metres/ 1.99 Squares
TOTAL 233.40 Square metres/ 25.08 Squares

LEGEND

-  Sky light
-  Air cond ducts