

# MAGAIN



3 Panalatinga Road REYNELLA EAST SA

3  2  3 

Contact Stuart Costello for viewing times.

Tucked away privately in a quiet cul-de-sac service road off of Panalatinga Road, this quality family home ticks all the right boxes.

As you drive down the long driveway you get a sense of stepping onto a 'country estate' rather than a regular suburban home. The residence comprises three spacious bedrooms and another room currently utilised as a formal dining but could easily be used as a fourth bedroom or office. The master bedroom is huge and features an ensuite and walk in robe along with access to the outside entertaining area. The rest of the home boasts a spacious lounge room with beautiful French doors, open living area,

[For full version visit the website](https://www.magain.com.au/property/3-panalatinga-road-reynella-east-sa/8431254)

**Type** : House  
**Building Size** : 16 sqm  
**View** : <https://www.magain.com.au/property/3-panalatinga-road-reynella-east-sa/8431254>

# 3 Panalatinga Road, Reynella East

Garden Shed

Paved Verandah

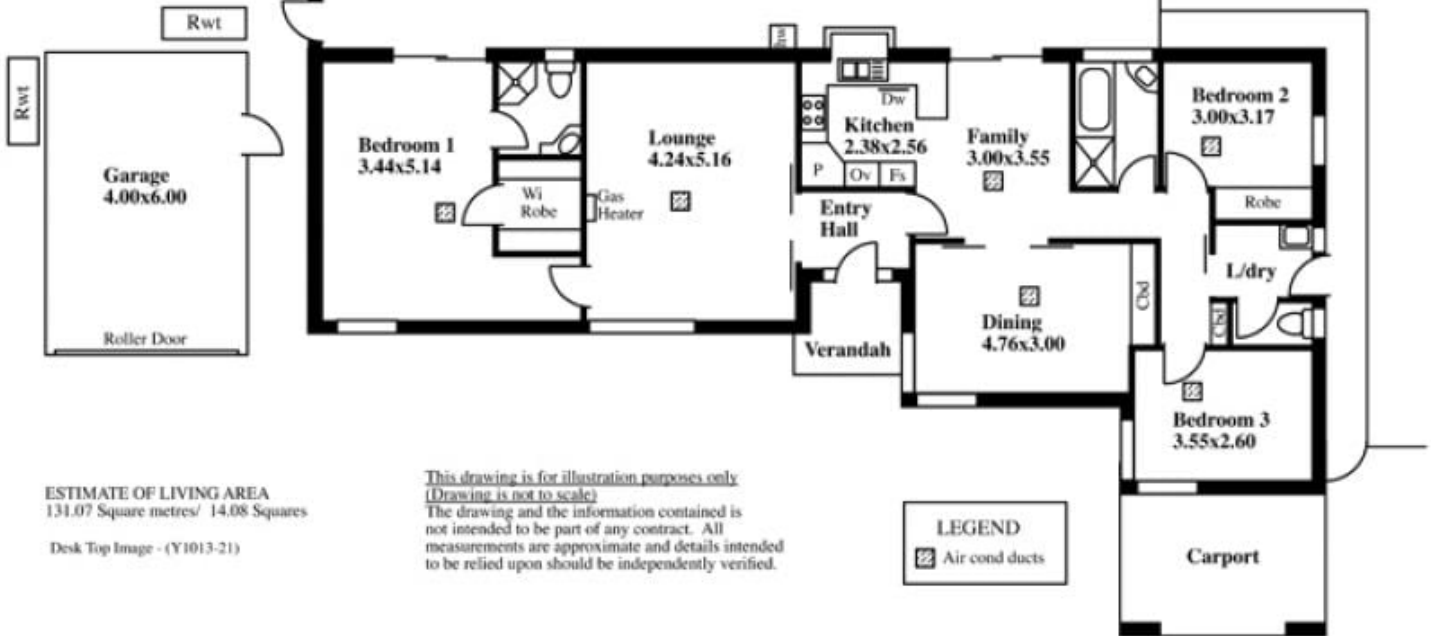

ESTIMATE OF LIVING AREA  
131.07 Square metres/ 14.08 Squares

Desk Top Image - (Y1013-21)

*This drawing is for illustration purposes only  
(Drawing is not to scale)*  
The drawing and the information contained is not intended to be part of any contract. All measurements are approximate and details intended to be relied upon should be independently verified.

LEGEND

▨ Air cond ducts