

# MAGAIN



1 Terra Avenue MITCHELL PARK SA

3  1  2 

Contact Stuart Costello for viewing times.

If you are looking for the perfect first family home look no further.

This boomerang style home, built in 1965 has a great layout and oodles of outdoor entertaining space.

It boasts a huge lounge and three great sized bedrooms with easy access to the updated family bathroom. It has a lovely kitchen/meals area and a big laundry.

the property has reverse cycle air conditioning and a gas heater for your year round comfort.

The outside gives you two spacious outdoor entertaining areas with access from the car ports automatic roller door, and a shed for storage.

A great house in a central location not to be missed. For more information or to register your interest please contact

**Type** : House

**Building Size** : 12 sqm

**Land Size** : 600 sqm

**View** : <https://www.magain.com.au/property/1-terra-avenue-mitchell-park-sa/8431306>

[For full version visit the website](https://www.magain.com.au)

<https://www.magain.com.au>  
Magain Real Estate

Shop 3, Happy Valley Shopping Centre, 50 Kenihans H  
08 8322 6111

1 Terra Avenue Mitchell Park, South Australia.

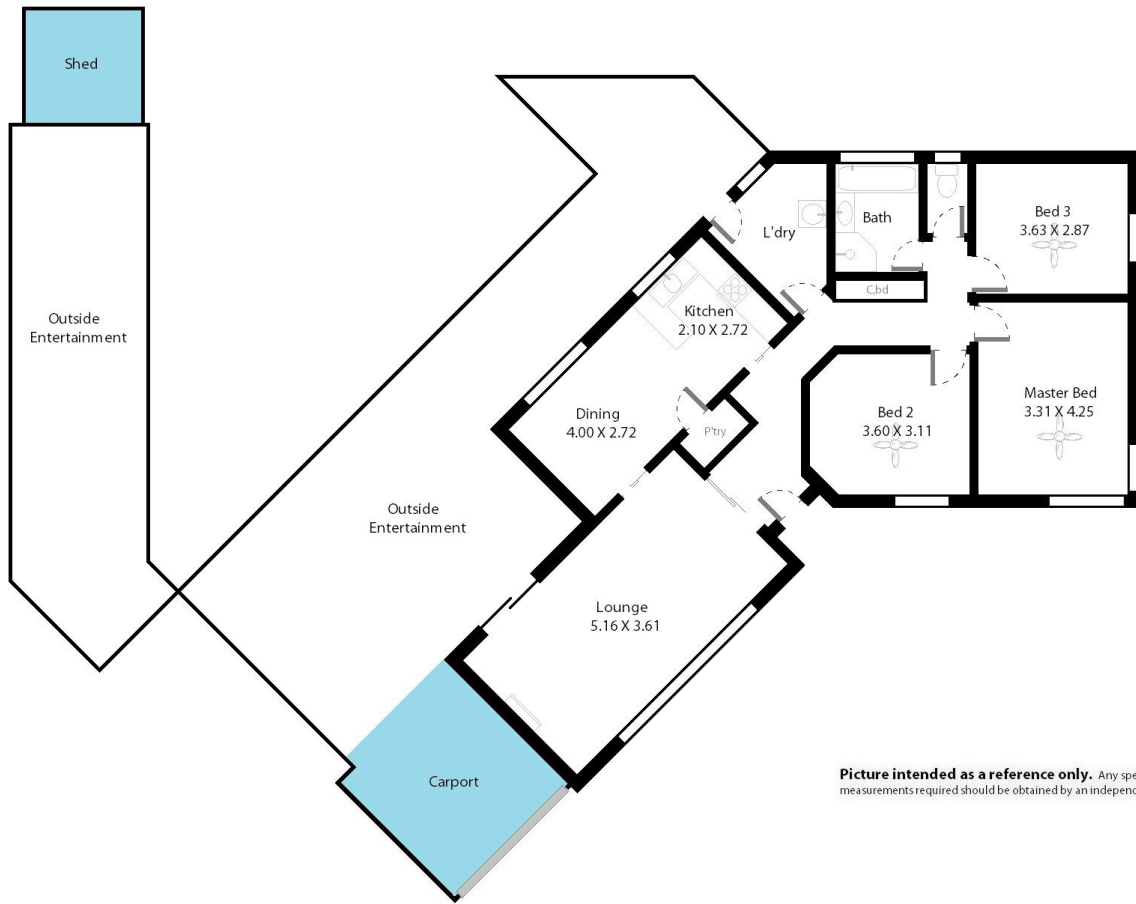

**Picture intended as a reference only.** Any specific measurements required should be obtained by an independent surveyor.