

MAGAIN



2/26 Myrtle Grove CLOVELLY PARK SA

3 1 1

Contact Stuart Costello for viewing times.

This brilliant quality home has everything for the first home buyer right through to family living. The privately tucked away front yard leads you to an immaculately presented spacious town house. Inside you are greeted with a modern and updated kitchen with Jarrah bench tops and a neutral living area. There are three good size bedrooms, the master with a built in robe, and a spacious bathroom, with a new shower screen. The property boasts new floors, new light fittings, new doors and a new hot water system. It also has ducted evaporative cooling. Outside there is a large landscaped yard and single car port. Conveniently located to all facilities and public transport this one is not to be missed.

Type : House
Building Size : 12 sqm
View : <https://www.magain.com.au/property/22-6-myrtle-grove-clovelly-park-sa/8431312>

Unit 2, 26 Myrtle Grove, Clovelly Park

UPSTAIRS

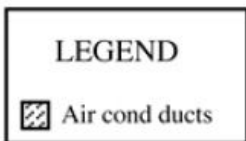
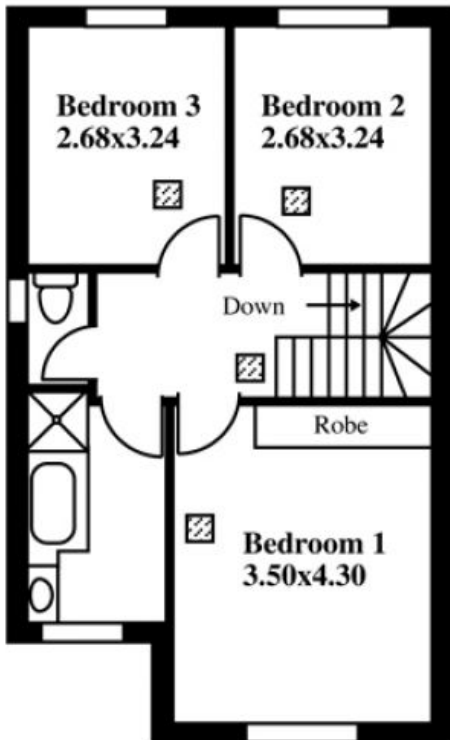

This drawing is for illustration purposes only
(Drawing is not to scale)

The drawing and the information contained is not intended to be part of any contract. All measurements are approximate and details intended to be relied upon should be independently verified.

ESTIMATE OF AREA

HOUSE
UPSTAIRS 55.47 Square metres/ 5.96 Squares

GROUND FLOOR 55.47 Square metres/ 5.96 Squares

TOTAL 110.94 Square metres/ 11.92 Squares

Desk Top Image - (Y0114-102)

GROUND FLOOR

