

MAGAIN



177 Coromandel Parade Coromandel Valley SA

5 🚗 5 🚗 12 🚗

INSPECTION BY APPOINTMENT

Please contact Karen Heuer for further details

'Warrawee House' - meaning 'stop here and rest a while'

History tells the story that this magnificent Turner Wood house was constructed in circa 1974. It was originally a quarry where stone from the property was carried to build the Horner's bridge in Coromandel Valley. In its formative years, it was a five star guest house, which has now been transformed into a luxurious family home offering a private and secure escape. An extremely impressive offering and one that deserves serious consideration.

Type : House
Price : \$ 1,707,000
Land Size : 16600 sqm
View : <https://www.magain.com.au/property/177-coromandel-parade-coromandel-valley-sa/8432320>



Karen Heuer
08 8381 6000

[For full version visit the website](https://www.magain.com.au)

<https://www.magain.com.au>
Magain Real Estate

Shop 3, Happy Valley Shopping Centre, 50 Kenihans H
08 8322 6111

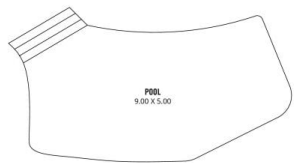
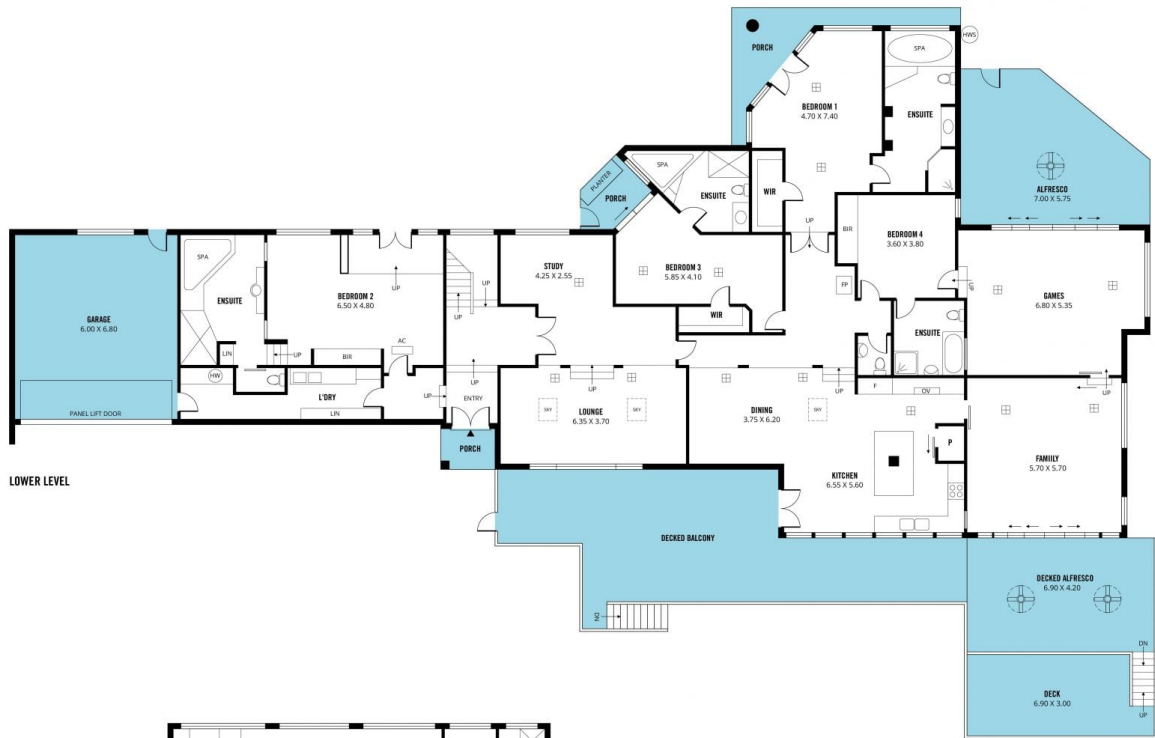

Scale in metres. This drawing is for illustration purposes only. All measurements are approximate and details intended to be relied upon should be independently verified.

Produced by The Fotobase Group