

MAGAIN



5 Chilcomb Drive HUNTFIELD HEIGHTS SA

3  1  4 

Beautifully situated opposite a parkland reserve with excellent kerbside appeal, this meticulously presented residence will surpass all your expectations and offers an array of valuable extras, including solar electricity (52c feed-in tariff), spectacular outdoor entertaining, large family room and drive through access to a powered rear double garage.

Internal presentation is flawless throughout a floorplan that includes three double bedrooms, stunning kitchen, and exquisite touches throughout the entire home.

The delightful formal lounge is graced with polished timber floors, ornate fireplace and pleasant outlooks over the parkland opposite.

[For full version visit the website](https://www.magain.com.au/property/5-chilcomb-drive-huntfield-heights-sa/8432782)

Type : House
Building Size : 17 sqm
Land Size : 720 sqm
View : <https://www.magain.com.au/property/5-chilcomb-drive-huntfield-heights-sa/8432782>

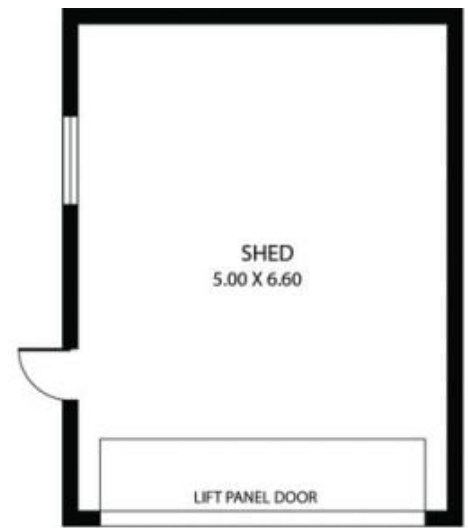
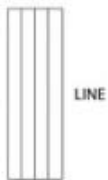

Scale in metres. This drawing is for illustration purposes only. All measurements are approximate and details intended to be relied upon should be independently verified.

Produced by **The Fotobase Group**