



# MAGAIN



4 Goss Road ABERFOYLE PARK SA

4  2  2 

Please contact Cameron Bowes today to discuss a viewing time Property.

Welcome to this beautifully presented property located in a quiet street amongst other high quality homes situated in the heart of the Craighburn Estate . As you enter this immaculate home you are sure to fall in love with the size, style and quality.

The home features a large formal lounge which includes a beautiful fire place. This is the perfect place to relax after a long day. The kitchen is perfect for the master chef, as it includes plenty of bench and cupboard space. It is sure to service the needs of the busy modern day family and overlooks the family room. There is also a massive rumpus

**Type** : House  
**Building Size** : 27 sqm  
**Land Size** : 889 sqm  
**View** : <https://www.magain.com.au/property/4-goss-road-aberfoyle-park-sa/8432830>

[For full version visit the website](https://www.magain.com.au)

<https://www.magain.com.au>  
Magain Real Estate

Shop 60, Seaford Central Shopping Centre, Commercial Road  
08 8366 2230

4 Goss Road Aberfoyle Park, South Australia.

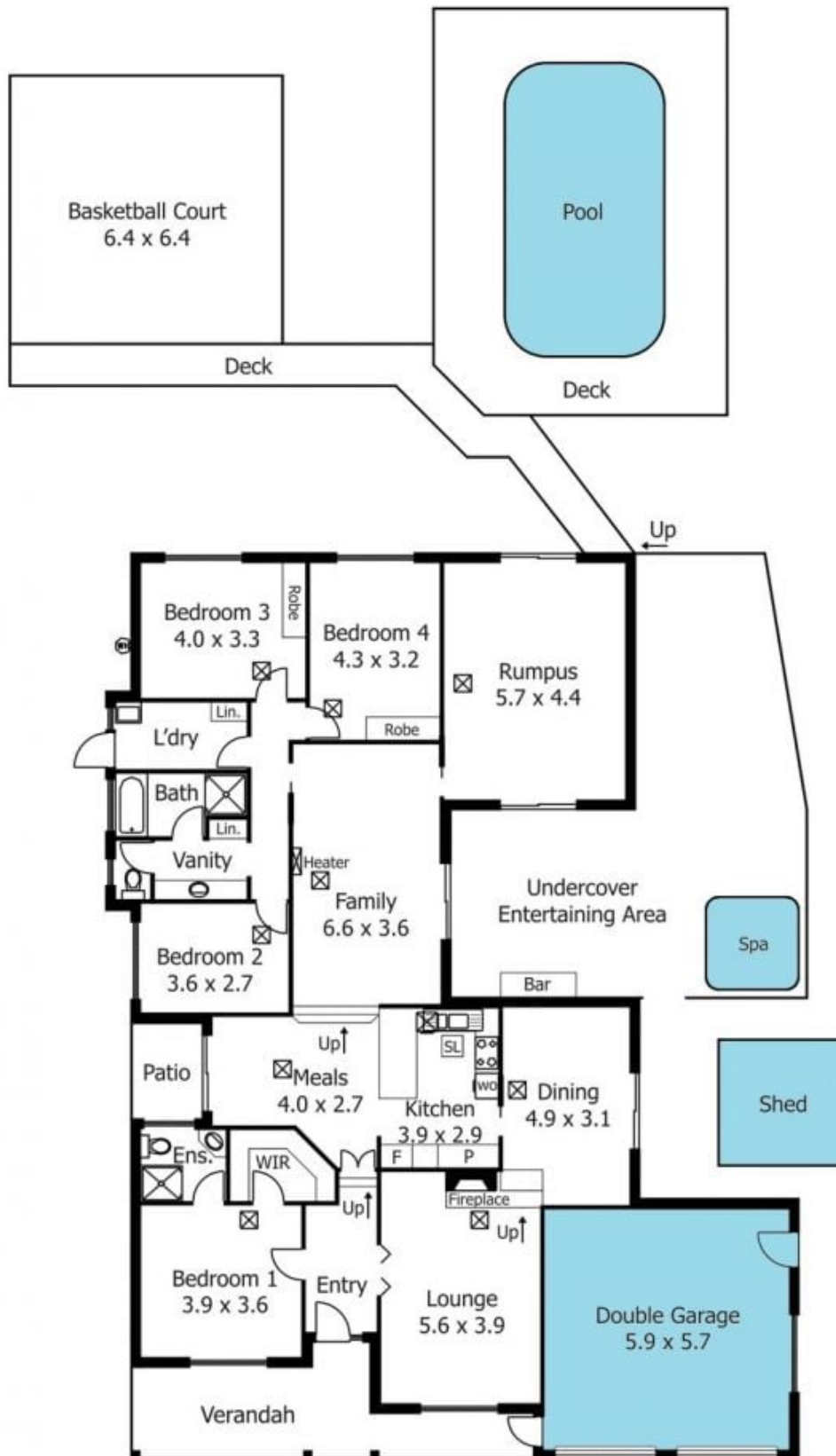

**Picture intended as a reference only.** Any specific measurements required should be obtained by an independent surveyor.