

MAGAIN



22 Parri Link NOARLUNGA DOWNS SA

3 2 1

This extremely neat and well maintained home is nestled amongst other quality homes in 'The Point' estate, located within easy access to the Southern Expressway, public transport options, a number of Schools and only a short drive to the coast.

This property could be an ideal 1st home, a great investment opportunity or perfect for a couple or small family. It is extremely low maintenance and in a great, convenient location.

The home offers a garage under the main roof with roller door access and private internal entry into the home. There is a double driveway for additional off street parking if required. The tiled entrance gives access to the spacious

Type : House
Building Size : 13 sqm
Land Size : 309 sqm
View : <https://www.magain.com.au/property/22-parri-link-noarlunga-downs-sa/8433373>



David Hams
08 8366 2230

[For full version visit the website](https://www.magain.com.au)

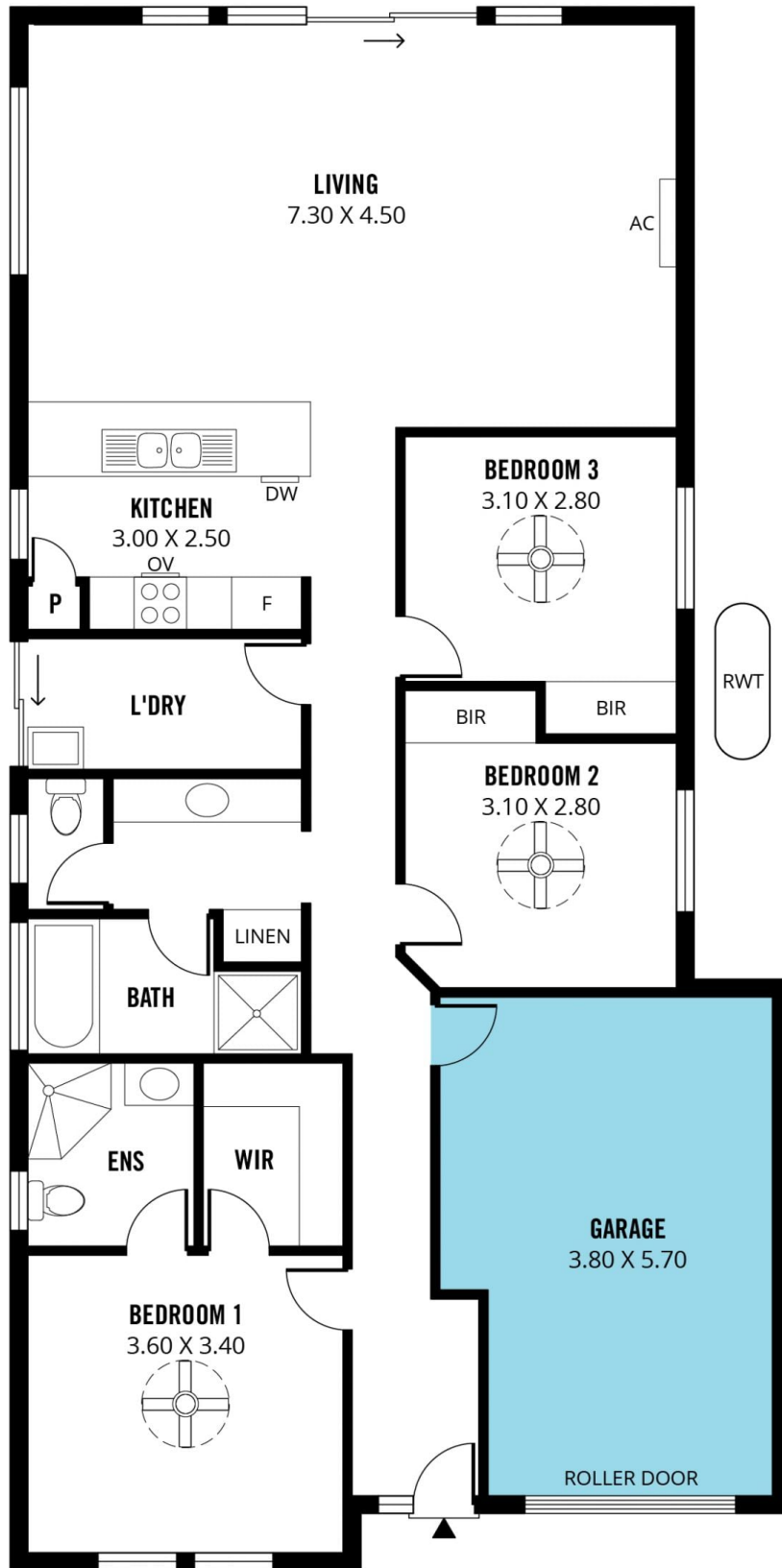

Scale in metres. This drawing is for illustration purposes only. All measurements are approximate and details intended to be relied upon should be independently verified. Produced by **The Fotobase Group**