

# MAGAIN



24 St Marys Street WILLUNGA SA

6 3 4

Contact David Hams for more information.

Nestled at the top of a no through road, within a short stroll to all that is on offer in the beautiful and historic Willunga township, including Farmers & Quarry markets, restaurants, galleries, sporting clubs and cafes. Sitting proudly on over 3,000m<sup>2</sup> land, this unique and impressive property has a number of benefits that simply do not become available very often.

This property boasts 2 completely separate dwellings, and has the potential for sub-division (stcc) if desired. The main house is a generous sized home that has recently been tastefully renovated and updated. As soon as you enter the impressive open plan main living area, you can't help but

**Type** : House  
**Land Size** : 3017 sqm  
**View** : <https://www.magain.com.au/property/24-st-marys-street-willunga-sa/8433748>



**David Hams**  
08 8366 2230

[For full version visit the website](https://www.magain.com.au)

<https://www.magain.com.au>  
Magain Real Estate

Shop 60, Seaford Central Shopping Centre, Commercial Road  
08 8366 2230

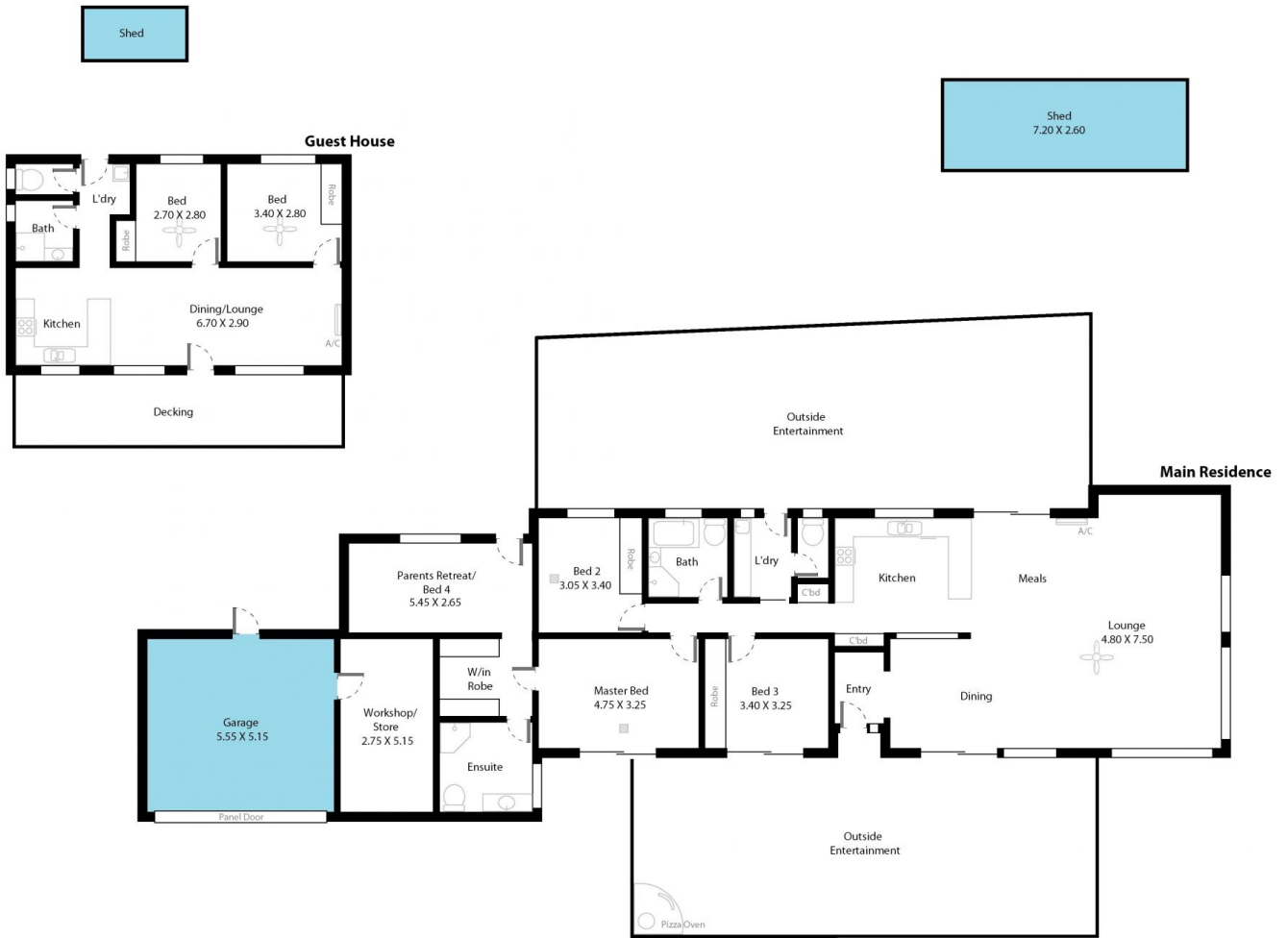

Picture intended as a reference only. Any specific measurements should be obtained by an independent surveyor.