

MAGAIN



12-14 Parham Crescent PORT NOARLUNGA SA

5  2  5 

One of Port Noarlungas truly unique and magnificent properties, this quintessential residence offers privacy, space, elegance and elements of resort living, sited on two titles and almost 1400 square meters - making it a significant land holding and future nest egg!

Excellent kerbside appeal is fully complemented by an expansive home, designed to perfectly accommodate the active family. Comprising five bedrooms including a beautiful master suite with walk-through robes, elegant ensuite and outlooks over wonderful grounds. Style is evident throughout the spacious living rooms, formal dining and an exquisite kitchen - the superb appointments combining modern panache with the homes original character.

[For full version visit the website](https://www.magain.com.au/property/12-14-parham-crescent-port-noarlunga-sa/8433783)

Type : House
Building Size : 27 sqm
Land Size : 1361 sqm
View : <https://www.magain.com.au/property/12-14-parham-crescent-port-noarlunga-sa/8433783>

12-14 Parham Court Port Noarlunga, South Australia.

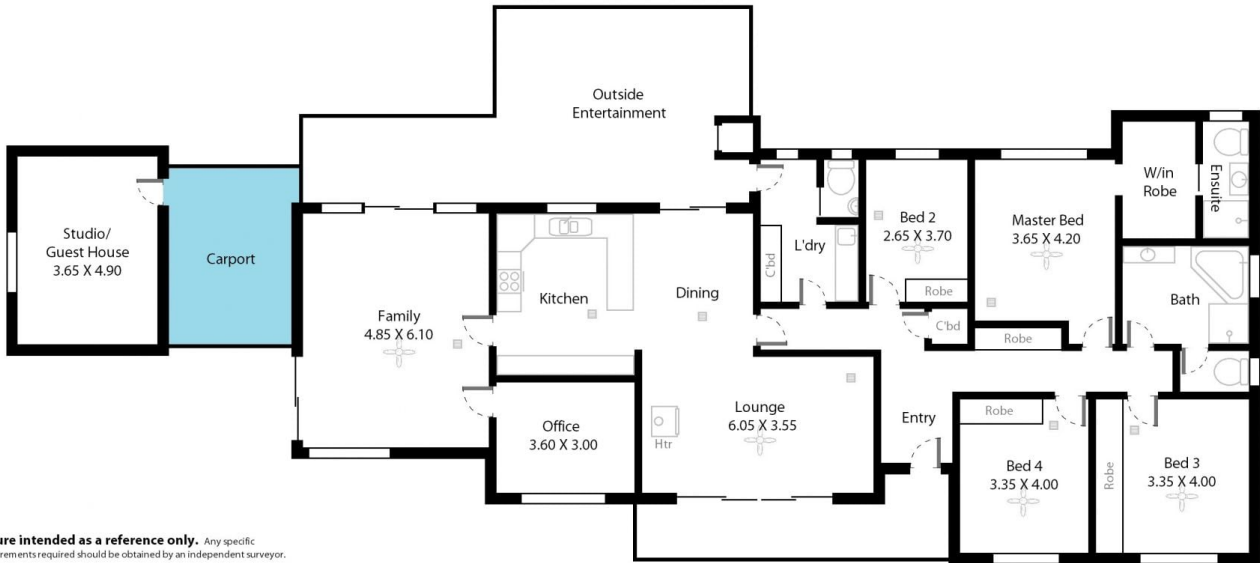
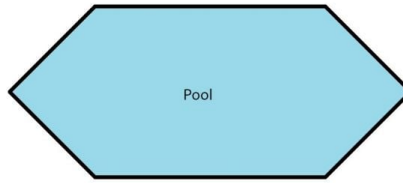
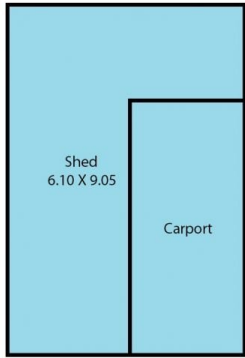

Picture intended as a reference only. Any specific measurements required should be obtained by an independent surveyor.