

MAGAIN



7 Leitch Avenue PORT NOARLUNGA SA

5 2 3

When looking for a family home one looks at the size, location, future opportunity and the feeling the home provides. Look no further, this stylish home certainly has all that and more situated on approximately 780m² of prime land with distant rear views of the ocean and dunes of Port Noarlunga. Across the road is a park for the kids and just a short stroll to the popular caf? scene, beach and jetty at Port Noarlunga.

The home is of solid brick construction and the versatile floor plan incorporates several options one can explore either 5 bedrooms and two living areas or 4 bedrooms and 3 living areas the choice is yours. Entering the home, you will flow through the inviting lounge room and into the spacious updated kitchen with 900mm oven, stainless range hood, dish washer and pantry with adjacent meals

Type : House
Building Size : 18 sqm
Land Size : 780 sqm
View : <https://www.magain.com.au/property/7-leitch-avenue-port-noarlunga-sa/8434030>



Jason Smart
08 8366 2230

[For full version visit the website](https://www.magain.com.au)

<https://www.magain.com.au>
Magain Real Estate

Shop 60, Seaford Central Shopping Centre, Commercial Road
08 8366 2230

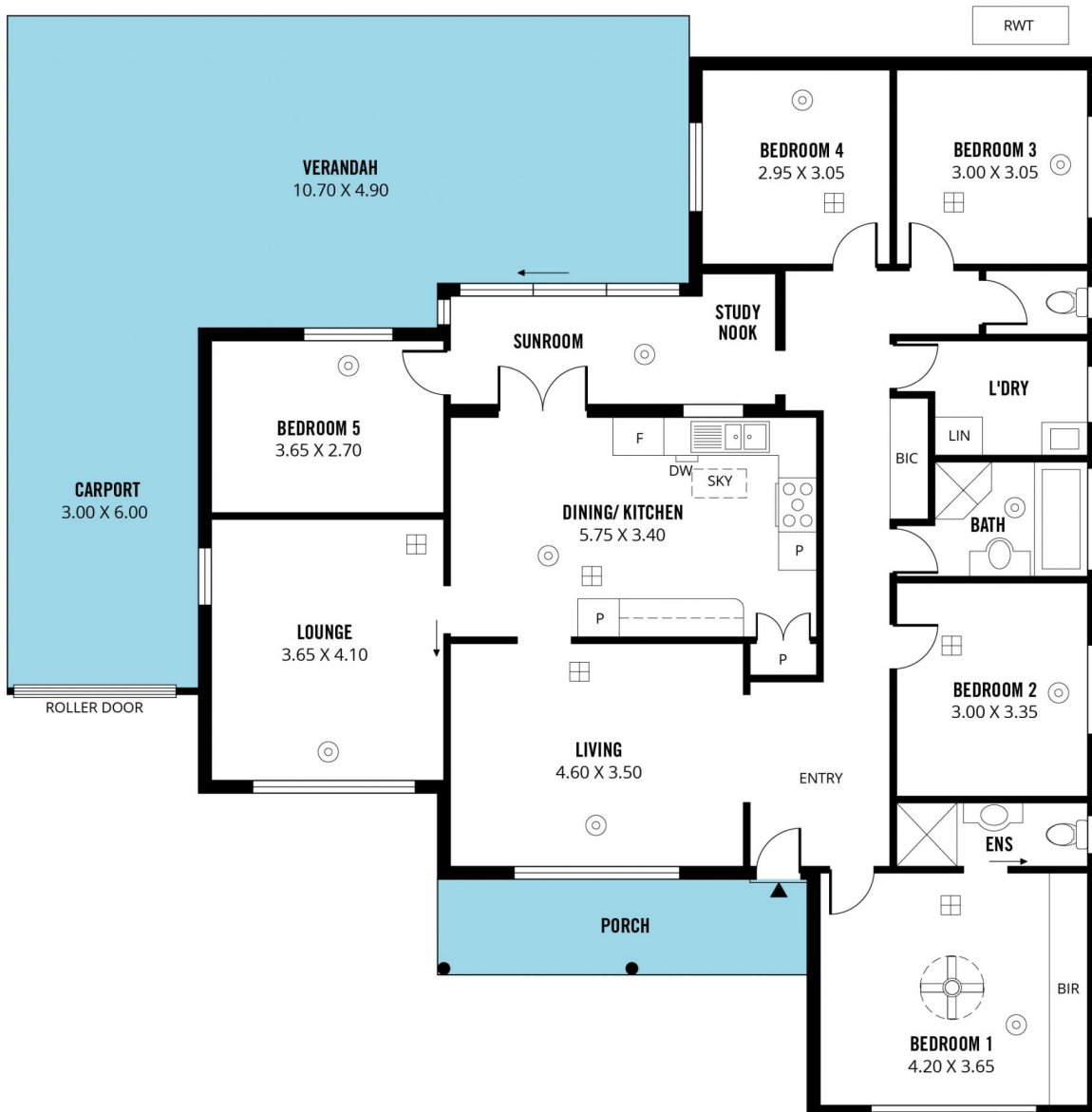
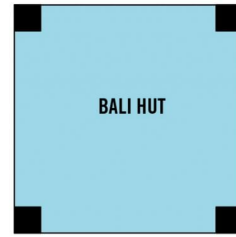
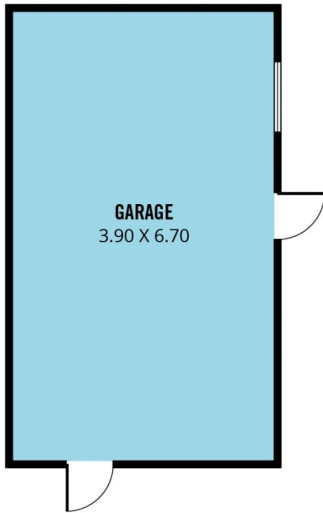

Scale in metres. This drawing is for illustration purposes only. All measurements are approximate and details intended to be relied upon should be independently verified.

Produced by **The Fotobase Group**