

MAGAIN



7 Passmore Avenue Port Noarlunga SA

3 1 4

Peacefully situated on an elevated block of 729m², just a couple of minutes from the delights of Port Noarlunga's eclectic township, cafes and world-class beaches - and with the lovely Onkaparinga River Recreation Park also just a couple of streets from your door, 7 Passmore Avenue is not just a home, but a lifestyle!

The property also offers all the conveniences of Noarlunga Centre, train station and Cardijn College within just a few minutes of home.

Architecturally designed with elevated outlooks and under-croft garage, the home takes in views across the wetlands and to the hills from its wonderful formal lounge, graced with cathedral ceilings and an abundance of natural light. From here, French doors take you out to a raised

Type : House
Price : \$ 680,000
Building Size : 169 sqm
Land Size : 729 sqm
View : <https://www.magain.com.au/property/7-passmore-avenue-port-noarlunga-sa/8434515>

[For full version visit the website](https://www.magain.com.au)

<https://www.magain.com.au>
Magain Real Estate

Shop 60, Seaford Central Shopping Centre, Commercial Road
08 8366 2230

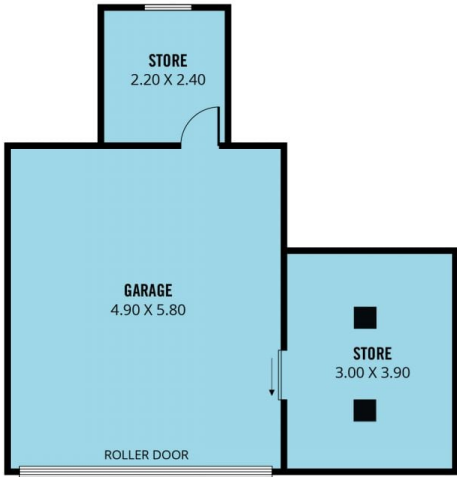

LOWER LEVEL



UPPER LEVEL



Scale in metres. This drawing is for illustration purposes only. All measurements are approximate and details intended to be relied upon should be independently verified.

Produced by The Fotobase Group