

MAGAIN



26 Hallett Avenue TRANMERE SA

3 1 2

INSPECT BY APPOINTMENT

Sensational opportunity in this premier Eastern Suburbs location to redevelop this superb land holding for either 2 new homes or large family home and make full use of the wide frontage (subject to all Council consents).

With a land area of approx 705sqm and a wide 24.3 metre frontage, the property offers a variety of possibilities.

Currently offering an existing 3 bedroom timber frame home in need of up-grading with potential for rental income while plans are being approved.

Located close to Firlie Shopping Centre, quality schools,

[For full version visit the website](https://www.magain.com.au/property/26-hallett-avenue-tranmere-sa/8435282)

Type : House
Land Size : 705 sqm
View : <https://www.magain.com.au/property/26-hallett-avenue-tranmere-sa/8435282>

26 Hallett Avenue TRANMERE

Garage

3.6m x 5.7m

Area	M ²
Living	94.57
Porch	2.78
Total	97.35

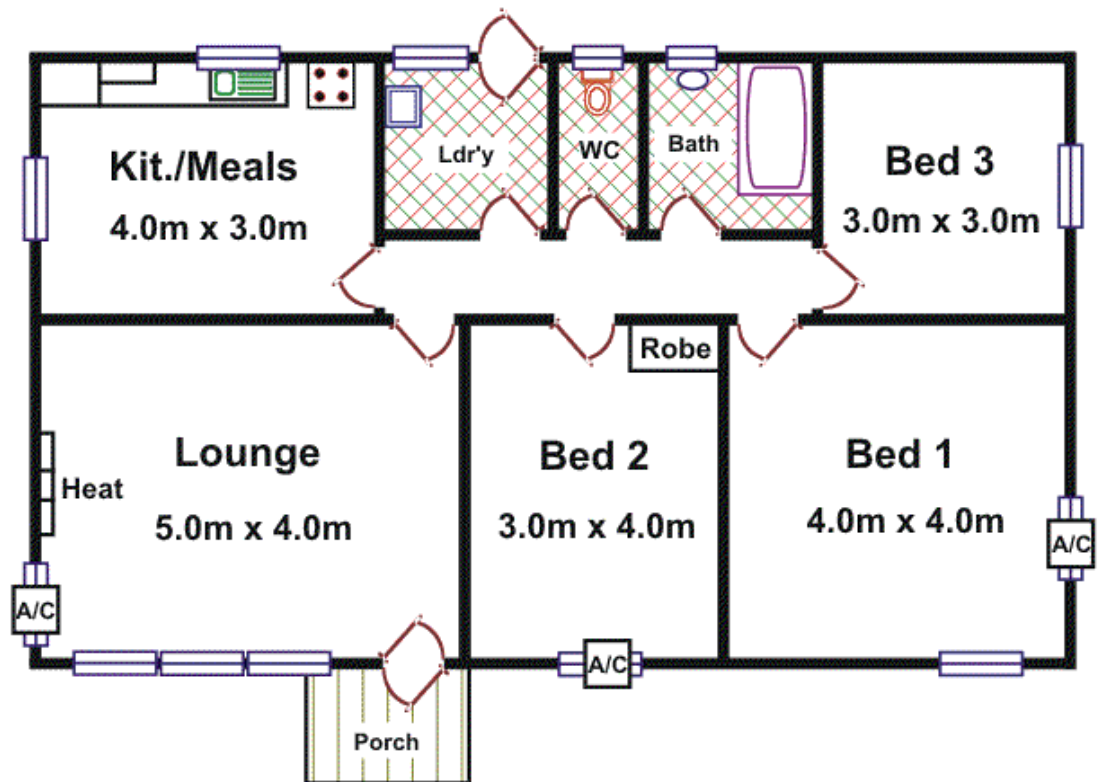

Please Note: Every care has been taken to verify the correctness of the areas and details used in this leaflet. However, the plan is not a surveyed plan and the dimensions given are estimates only. No warranty or representation is given or made as to the correctness of the information supplied and neither the owners nor the Agents can accept responsibility for errors or omissions.